



No 346

JACKSONVILLE WASTEWATER UTILITY

RESIDENTIAL OR COMMERCIAL BUILDING SEWER CONNECTION PERMIT

Street Address 408 E. Trickey

Legal Description \_\_\_\_\_

Facility to be connected to sewer: replacement

Single Family Residence ☒ \*Multi-family Residential \_\_\_\_\_ Units \_\_\_\_\_

\*Commercial Installation \_\_\_\_\_ Description: \_\_\_\_\_

Water Meter (s) size \_\_\_\_\_

\*Commerical installations, and multi-family installations of more than 4 dwelling units must be accompanied by a site plan showing the proposed building sewer.

Sewer line installation by Johnson Plumbing

Address 1104 N Gray

General Co \_\_\_\_\_

Address \_\_\_\_\_

In consider \_\_\_\_\_

1. To acc \_\_\_\_\_
2. To mai  
connec \_\_\_\_\_
3. To noti  
and co  
cover \_\_\_\_\_

Fees: \_\_\_\_\_ Receipt No. \_\_\_\_\_

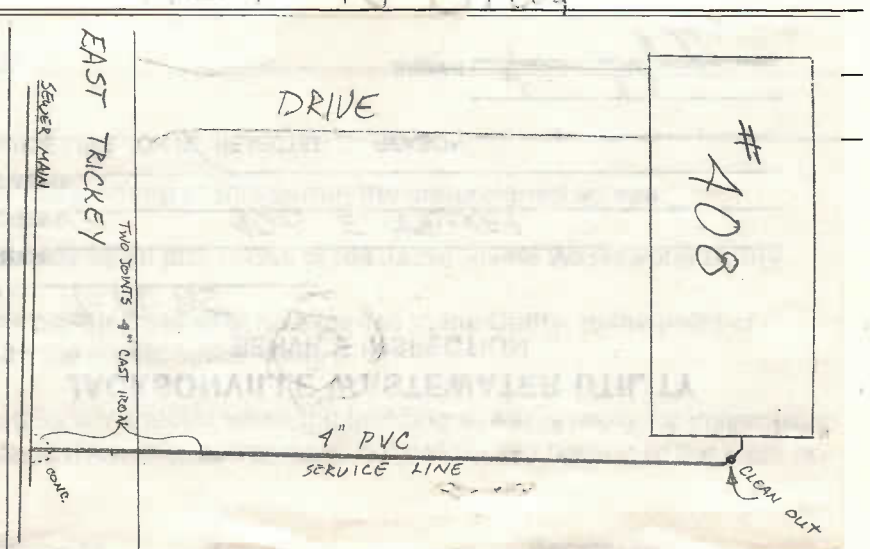

APPLIC  
Signed ☐ ☐ ☐

APPRO  
Jacksc

By: \_\_\_\_\_ Date: \_\_\_\_\_

