



No. 07- 0001

JACKSONVILLE WASTEWATER UTILITY

248 Cloverdale Rd.
Jacksonville, AR 72076
501-982-0581

RESIDENTIAL OR COMMERCIAL BUILDING SEWER CONNECTION PERMIT

Street Address 409 Neal Street

Legal Description _____

Facility to be connected to sewer:

Single Family Residence ☒ *Multi-family Residential _____ Units _____

*Commercial Installation _____ Description: Street Out

Water Meter (s) Size 5/8"

* Commercial installations, and multi-family installations of more than 4 dwelling units must be accompanied by a site plan showing the proposed building sewer.

Sewer line installation by AAA Plumbing / JWU

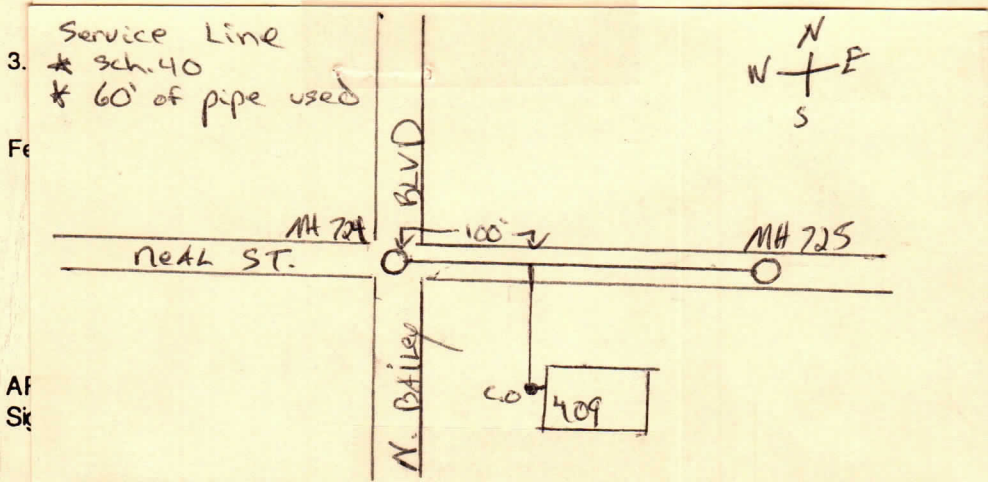
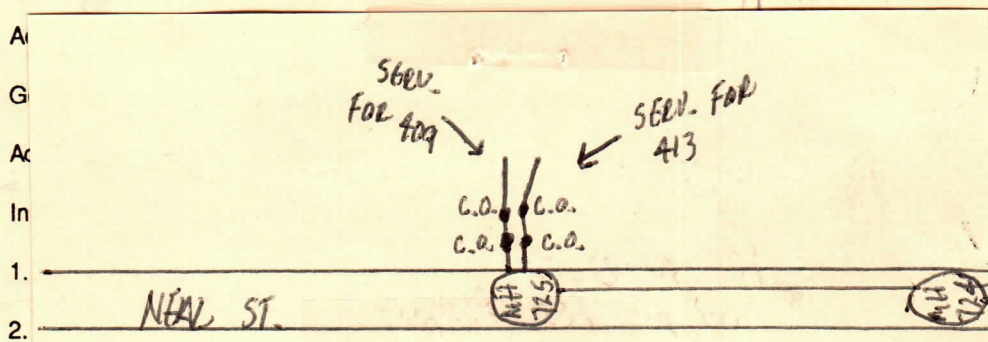

☐ Owner (Address Arlene Moore)

501-982-4826

APPROVED

Jacksonville Wastewater Utility

By: Jessica Kendrick

Date: 1-17-07

Just - Inspected
1-23-07
Final
1-25-07