



No. 06- 0301

## JACKSONVILLE WASTEWATER UTILITY

248 Cloverdale Rd.  
Jacksonville, AR 72076  
501-982-0581

## RESIDENTIAL OR COMMERCIAL BUILDING SEWER CONNECTION PERMIT

Street Address 413 Cypress CourtLegal Description Lot 33 F Oakridge Ranch

Facility to be connected to sewer:

Single Family Residence ☒ \*Multi-family Residential \_\_\_\_\_ Units \_\_\_\_\_

\*Commercial Installation \_\_\_\_\_ Description: \_\_\_\_\_

Water Meter (s) Size 5/8

\* Commercial installations, and multi-family installations of more than 4 dwelling units must be accompanied by a site plan showing the proposed building sewer.

Sewer line installation by Harden Plumber 944 7380

Address \_\_\_\_\_

General Contractor Smith HomesAddress P.O. Box 7247 NLC

In consideration of the granting of this permit the under

1. To accept and abide by all provisions of the Jackson
2. To maintain the building sewer at no expense to the public sewer main.
3. To notify the utility's inspector when the building sewer to the public sewer main, but before any portion of the

Fees: Connection Fee \$ 75.00Tap Charge \$ 49.22Inspection Fee \$ 12.00

Street Cut \$ \_\_\_\_\_

## APPLICANT

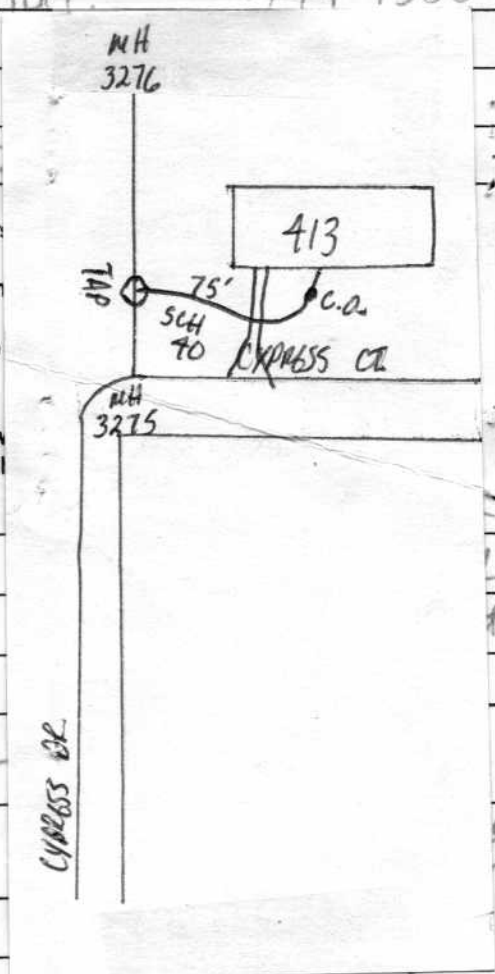
Signed Andy Smith☐ Plumbing Contractor☐ General Contract☐ Owner (Address \_\_\_\_\_)APPROVED  
Jacksonville Wastewater UtilityBy: Loan Davitt Date: 10-18-06