



No. 94- 006

JACKSONVILLE WASTEWATER UTILITY
248 Cloverdale Road · P.O. Box 69
Jacksonville, AR 72078-0069
982-0581

RESIDENTIAL OR COMMERCIAL BUILDING SEWER CONNECTION PERMIT

Street Address 415 Mulberry St

Legal Description _____

Facility to be connected to sewer:

Single Family Residence _____ *Multi-family Residential ☒ Units _____

*Commercial Installation _____ Description: _____

Water Meter (s) Size 2"

* Commercial installations, and multi-family installations of more than 4 dwelling units must be accompanied by a site plan showing the proposed building sewer.

Sewer line installation by Pratt Plumbing

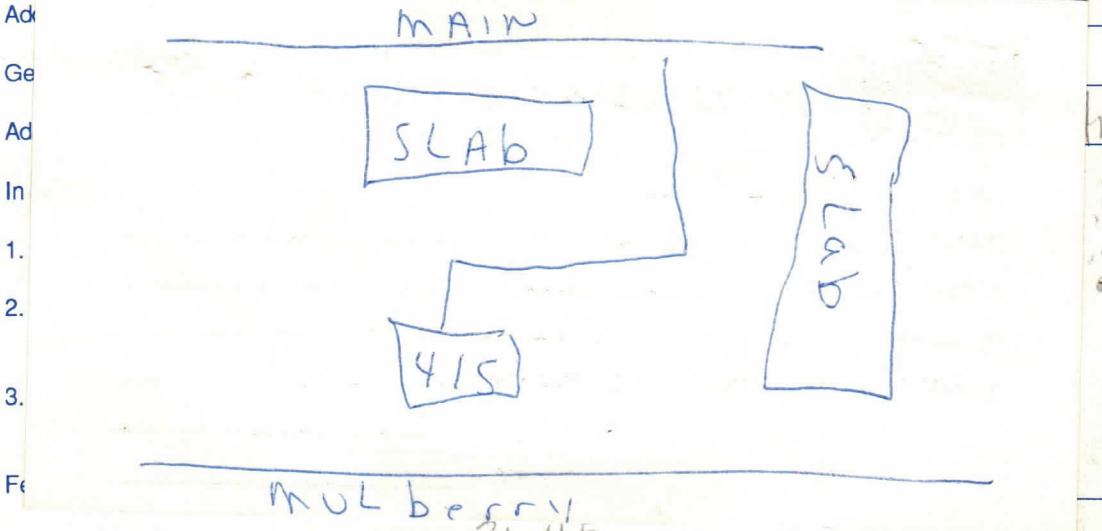

Tap Charge \$ 31.45

Receipt No. _____

Inspection Fee \$ 6.00

Receipt No. _____

Total Fees \$ 237.45

APPLICANT
Signed Pratt Plbg Contr by S.P. Hook
☐ Plumbing Contractor
☐ General Contract
☐ Owner (Address _____)

APPROVED
Jacksonville Wastewater Utility

By: Susan Young Date: 1-26-94



No. 94- 103

JACKSONVILLE WASTEWATER UTILITY

248 Cloverdale Road • P.O. Box 69
Jacksonville, AR 72078-0069
982-0581

RESIDENTIAL OR COMMERCIAL BUILDING SEWER CONNECTION PERMIT

Street Address 415 Trucking

Legal Description _____

Facility to be connected to sewer:

Single Family Residence _____ *Multi-family Residential _____ Units 4

*Commercial Installation 2216 Description: Hammer Atkins Co.

Water Meter (s) Size 1" 110

* Commercial installations, and multi-family installations of more than 4 dwelling units must be accompanied by a site plan showing the proposed building sewer.

Sewer line

Address _____

General

Address _____

In consid

1. To ac

2. To m
publi

3. To n
to th

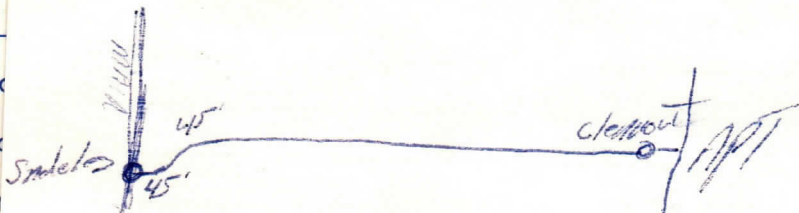

Fees:	Connection Fee	\$	
	Tap Charge	\$	104.41
	Inspection Fee	\$	18.00
	Total Fees	\$	122.41

APPLICANT

Signed See permit # 94-

- ☐ Plumbing Contractor
- ☐ General Contract
- ☐ Owner (Address _____)

APPROVED

Jacksonville Wastewater Utility

By: James Arnold

Di

