



JACKSONVILLE WASTEWATER UTILITY

248 Cloverdale Rd.
Jacksonville, AR 72076
501-982-0581

No. 08-0035

RESIDENTIAL OR COMMERCIAL BUILDING SEWER CONNECTION PERMIT

Street Address 425 W. Main

Legal Description _____

Facility to be connected to sewer:

Single Family Residence ☒ *Multi-family Residential _____ Units _____

*Commercial Installation _____ Description: Replacement

Water Meter (s) Size 5/8"

* Commercial installations, and multi-family installations of more than 4 dwelling units must be accompanied by a site plan showing the proposed building sewer.

Sewer line installation by Master Plumber Charles

Address _____

General SO. BRADLEY BLVD

Address _____

In consideration of _____

1. To accept _____

2. To maintain public _____

3. To notify the _____

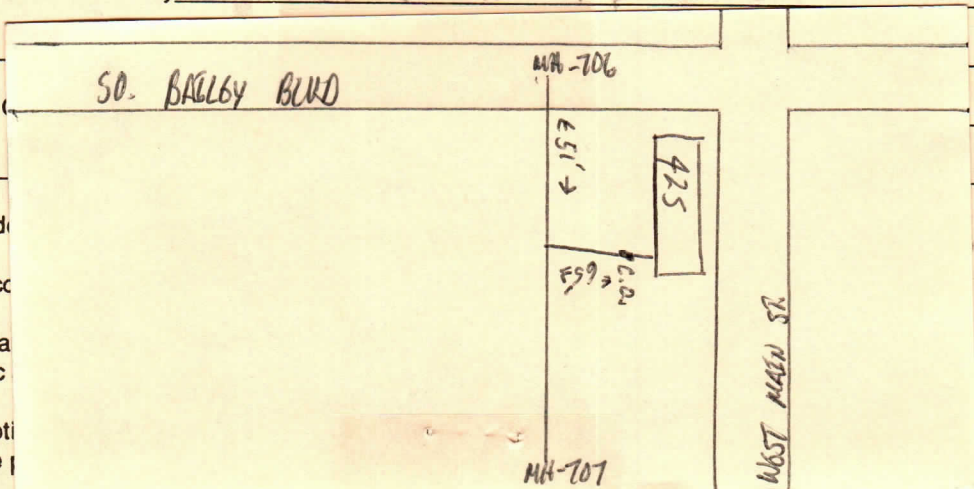

Fees: Connection Fee \$ _____ Receipt No. _____

Tap Charge \$ _____ Receipt No. _____

Inspection Fee \$ 12.00 Receipt No. n Acct

Street Cut \$ _____ Receipt No. _____

APPLICANT Signed n file

- ☐ Plumbing Contractor
☐ General Contract
☐ Owner (Address _____)

APPROVED Jacksonville Wastewater Utility

By: Sandra Kendrick Date: 3-10-08

Handwritten: 3-11-08

Handwritten: Completed 3-11-08