



No. 96-049

# JACKSONVILLE WASTEWATER UTILITY

248 Cloverdale Road • P.O. Box 69  
Jacksonville, AR 72078-0069  
982-0581

## RESIDENTIAL OR COMMERCIAL BUILDING SEWER CONNECTION PERMIT

Street Address 4511 Penn Pointe  
Legal Description lot # 8 Penn pointe Subd. Phase II

Facility to be connected to sewer:

Single Family Residence ☒ \*Multi-family Residential \_\_\_\_\_ Units \_\_\_\_\_

\*Commercial Installation \_\_\_\_\_ Description: \_\_\_\_\_

Water Meter (s) Size 5/8

\* Commercial installations, and multi-family installations of more than 4 dwelling units must be accompanied by a site plan showing the proposed building sewer.

Sewer line installation by Don Hough

Address \_\_\_\_\_

Ge

Ad

In

1.

2.

3.

Fe

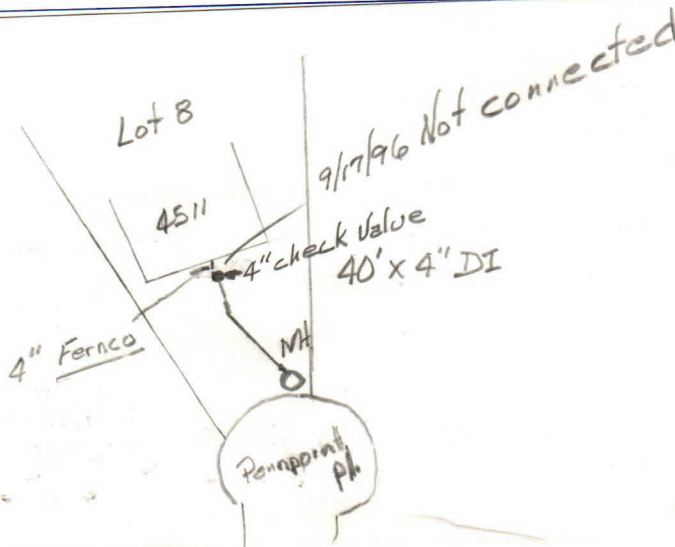

Inspection Fee \$ 6.00

Receipt No. 6619

A  
S

A  
J  
E

