



JACKSONVILLE WASTEWATER UTILITY
248 Cloverdale Rd.
Jacksonville, AR 72076
501-982-0581

No. 13-0017

RESIDENTIAL OR COMMERCIAL BUILDING SEWER CONNECTION PERMIT

Street Address 4602 B4 Letter Park Loop

Legal Description _____

Facility to be connected to sewer:

Single Family Residence ☒ *Multi-family Residential _____ Units _____

*Commercial Installation _____ Description: New Connection

Water Meter (s) Size 5/8"

* Commercial installations, and multi-family installations of more than 4 dwelling units must be accompanied by a site plan showing the proposed building sewer.

Sewer line installation by _____

Address 4602 Letter Loop Park 98'

General C Apt B4, B5, B6

Address 260' sch 40-4" 0 ft to m # 3608

In consider _____

1. To acc _____

2. To ma public _____

3. To not to the _____

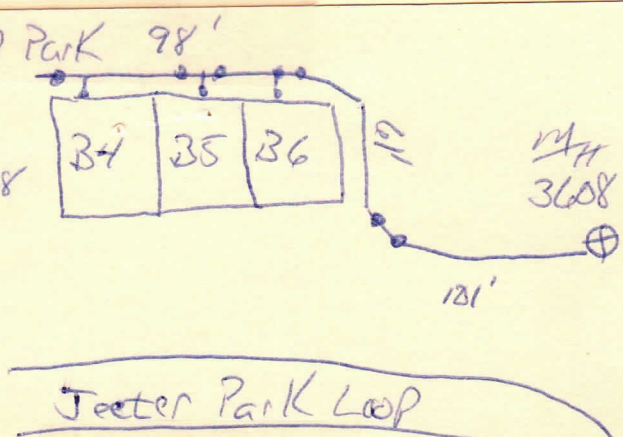

Fees: Connection Fee \$ ~~15.00~~ 0

Receipt No. 450050 med 4/25/13

Tap Charge \$ _____

Receipt No. _____

Inspection Fee \$ ~~25.00~~ 0

Receipt No. MC returned 4/25/13

Street Cut \$ _____

Receipt No. _____

APPLICANT Signed Travis Akins

☐ Plumbing Contractor

☐ General Contract

☐ Owner (Address _____)

Travis Akins - owner

501.607 1493

complete 10/19/13

APPROVED
Jacksonville Wastewater Utility

By: Jessica Kendrick Date: 2/8/13