



JACKSONVILLE WASTEWATER UTILITY

248 Cloverdale Rd.
Jacksonville, AR 72076
501-982-0581

No. 13- 0211

RESIDENTIAL OR COMMERCIAL BUILDING SEWER CONNECTION PERMIT

Street Address 4910 Englewood

Legal Description _____

Facility to be connected to sewer:

Single Family Residence ☒ *Multi-family Residential _____ Units _____

*Commercial Installation _____ Description: New Connection

Water Meter (s) Size 5/8

* Commercial installations, and multi-family installations of more than 4 dwelling units must be accompanied by a site plan showing the proposed building sewer.

Sewer line installation by Larry Norman - 541-9900

Address _____

General _____

Address _____

In cons _____

1. To _____

2. To _____
pub _____

3. To _____
to th _____

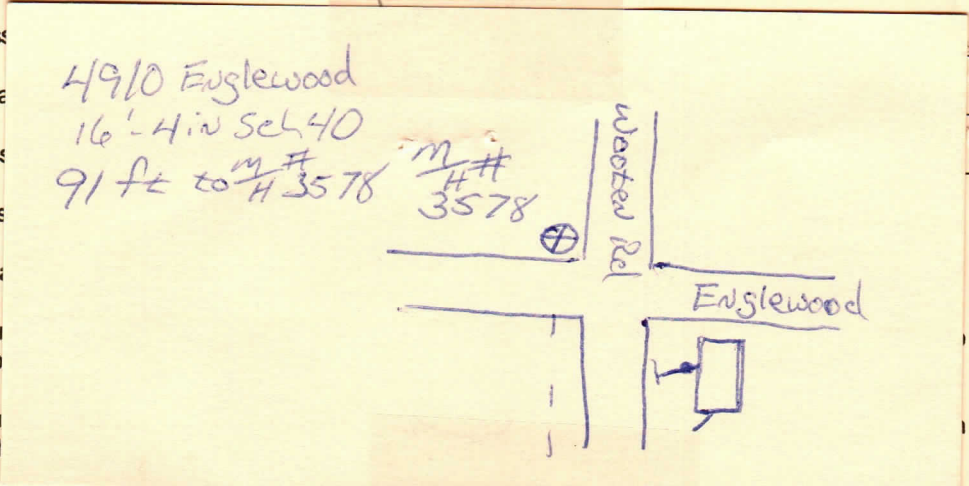

Fees: Connection Fee \$ 0 Receipt No. nc

Tap Charge \$ _____ Receipt No. _____

Inspection Fee \$ 0 Receipt No. nc

Street Cut \$ _____ Receipt No. _____

APPLICANT
Signed Larry Norman

☒ Plumbing Contractor

☐ General Contract

☐ Owner (Address _____)

APPROVED
Jacksonville Wastewater Utility

By: Victor Reed Date: 9/25/13

Complete
10/9/13