



JACKSONVILLE WASTEWATER UTILITY

248 Cloverdale Rd.
Jacksonville, AR 72076
501-982-0581

No. 13-0013

RESIDENTIAL OR COMMERCIAL BUILDING SEWER CONNECTION PERMIT

Street Address 501 N James

Legal Description _____

Facility to be connected to sewer:

Single Family Residence _____ *Multi-family Residential _____ Units _____

*Commercial Installation _____ Description: Replacement

Water Meter (s) Size 5/8

* Commercial installations, and multi-family installations of more than 4 dwelling units must be accompanied by a site plan showing the proposed building sewer.

Sewer line installation by Ron's X-press Plumbing Ben 416-6079

Address 501 N. James St

General C 62 ft sch 40-4"

Address 77 ft to 0' H 747

In consider

1. To acc

2. To mai
public s

3. To noti
to the p

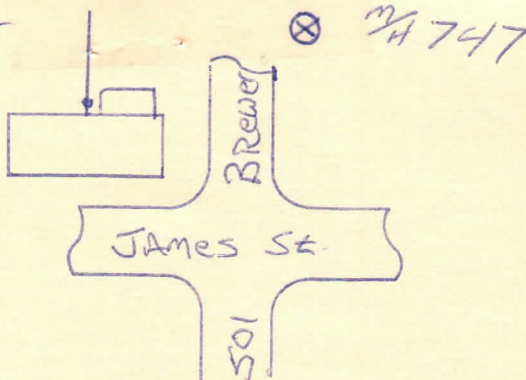

Fees: Connection Fee \$ _____

Receipt No. _____

Tap Charge \$ _____

Receipt No. _____

Inspection Fee \$ 25.00

Receipt No. 150038

Street Cut \$ _____

Receipt No. _____

APPLICANT

Signed

☐ Plumbing Contractor

☐ General Contract

☐ Owner (Address _____)

APPROVED

Jacksonville Wastewater Utility

By: Chris Ward

Date: 1/31/13

Complete
1/31/13