



# JACKSONVILLE WASTEWATER UTILITY

248 Cloverdale Rd.  
Jacksonville, AR 72076  
501-982-0581

No. 10-0000188

## RESIDENTIAL OR COMMERCIAL BUILDING SEWER CONNECTION PERMIT

Street Address 509 Lehman Drive

Legal Description \_\_\_\_\_

Facility to be connected to sewer:

Single Family Residence ☒ \*Multi-family Residential \_\_\_\_\_ Units \_\_\_\_\_

\*Commercial Installation \_\_\_\_\_ Description: Repair

Water Meter (s) Size 5/8"

\* Commercial installations, and multi-family installations of more than 4 dwelling units must be accompanied by a site plan showing the proposed building sewer.

Sewer line installation by Homeowner

Address 67 67

General \_\_\_\_\_

Address \_\_\_\_\_

In consid \_\_\_\_\_

1. To a \_\_\_\_\_

2. To m \_\_\_\_\_  
publi \_\_\_\_\_

3. To n \_\_\_\_\_  
to the LEHMAN DR

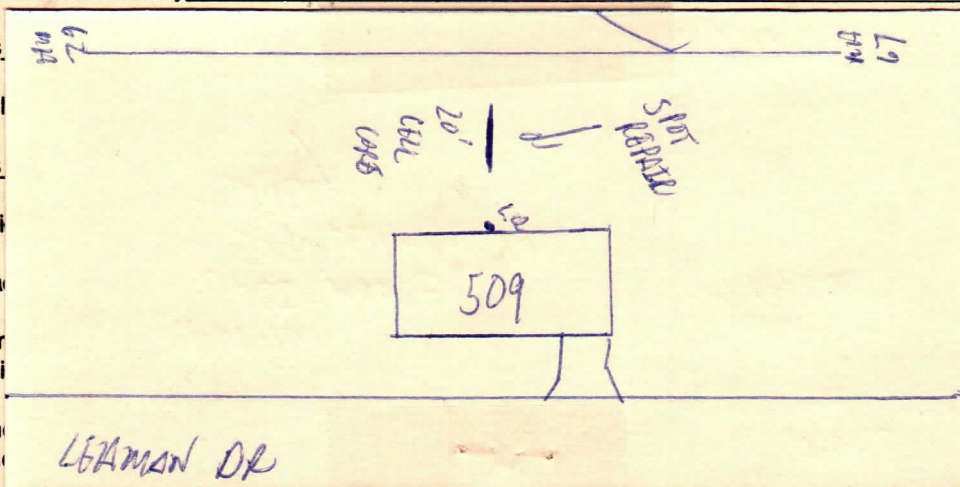

Fees: Connection Fee \$ \_\_\_\_\_ Receipt No. \_\_\_\_\_

Tap Charge \$ \_\_\_\_\_ Receipt No. \_\_\_\_\_

Inspection Fee \$ 25.00 Receipt No. 241032

Street Cut \$ \_\_\_\_\_ Receipt No. \_\_\_\_\_

APPLICANT  
Signed Jaqueline Moore

☐ Plumbing Contractor

☐ General Contract

☐ Owner (Address Jaqueline Moore)

501-241 0086

APPROVED  
Jacksonville Wastewater Utility

By: Jaqueline Moore Date: 11-1-10

Complete  
11/1/10