



JACKSONVILLE WASTEWATER UTILITY
SERVICE INSPECTION

PERMIT NO. _____

DATE: March 7, 1997

OWNER: _____

ADDRESS: 509 PoplarPLUMBER: unknownSERVICE LINE: OK ☐ REJECTED ☒ REASON: poor workmanship;
pipe glued not done properly

JACKSONVILLE WASTEWATER UTILITY
SERVICE INSPECTION

PERMIT NO. _____

DATE: 3-10-97

OWNER: _____

ADDRESS: 509 PoplarPLUMBER: ownerSERVICE LINE: OK ☐ REJECTED ☒ REASON: not watertight;
poor workmanship

JACKSONVILLE WASTEWATER UTILITY
SERVICE INSPECTION

PERMIT NO. _____

DATE: March 12, 1997

OWNER: _____

ADDRESS: 509 PoplarPLUMBER: unknownSERVICE LINE: OK ☐ REJECTED ☒ REASON: failed smoke test

JACKSONVILLE WASTEWATER UTILITY
SERVICE INSPECTION

PERMIT NO. _____

DATE: 1-27-98

OWNER: _____

ADDRESS: 509 Poplar

PLUMBER: _____

SERVICE LINE: OK ☒ REJECTED ☐ REASON: _____O.K. passed

SIGNED

Kevin D. Dill



No. 01041

JACKSONVILLE WASTEWATER UTILITY

248 Cloverdale Road · P.O. Box 69
Jacksonville, AR 72078-0069
982-0581

RESIDENTIAL OR COMMERCIAL BUILDING SEWER CONNECTION PERMIT

Street Address 509 Poplar

Legal Description _____

Facility to be connected to sewer:

Single Family Residence ☒ *Multi-family Residential _____ Units _____

*Commercial Installation _____ Description: repair

Water Meter (s) Size 5/8

* Commercial installations, and multi-family installations of more than 4 dwelling units must be accompanied by a site plan showing the proposed building sewer.

Sewer line installation by AAA Plumbing

Address _____

General _____

Address _____

In code _____

1. To _____

2. To _____

3. To _____

to _____

Fees _____

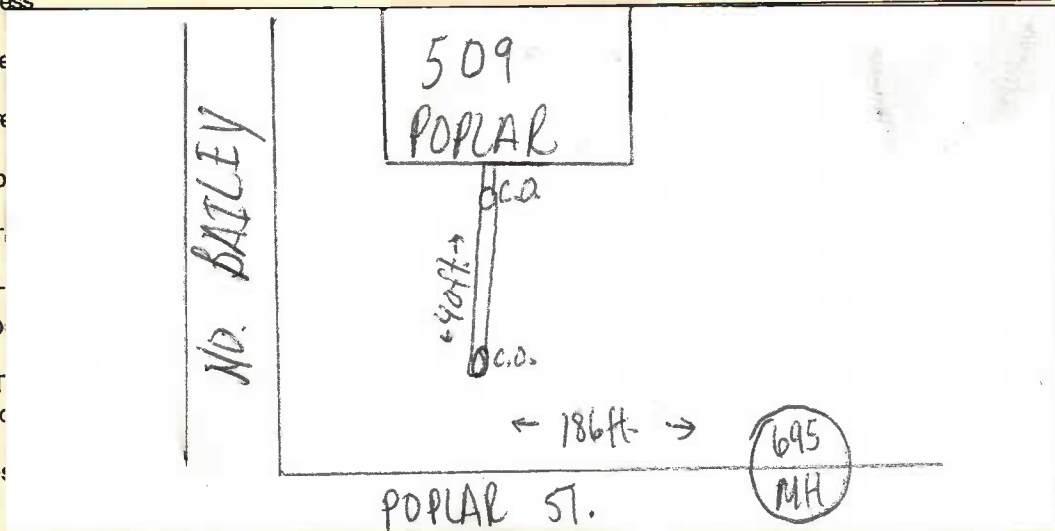

Inspection Fee \$ 6.00

Receipt No. 2781

Total Fees \$ 6.00

APPLICANT

Signed per phone service

☐ Plumbing Contractor

☐ General Contract

☐ Owner (Address _____)

APPROVED
Jacksonville Wastewater Utility

By: Kathy Bent Date: 1-24-01



JACKSONVILLE WASTEWATER UTILITY
248 Cloverdale Rd.
Jacksonville, AR 72076
501-982-0581

No. 15- 000004

RESIDENTIAL OR COMMERCIAL BUILDING SEWER CONNECTION PERMIT

Street Address 509 Poplar Street

Legal Description _____

Facility to be connected to sewer:

Single Family Residence ☒ *Multi-family Residential _____ Units _____

*Commercial Installation _____ Description: Repair

Water Meter (s) Size 5/8"

* Commercial installations, and multi-family installations of more than 4 dwelling units must be accompanied by a site plan showing the proposed building sewer.

Sewer line installation by AX Water Matt

Address _____

General _____

Address _____

In cons _____

1. To _____

2. To _____

pub _____

3. To _____

to th _____

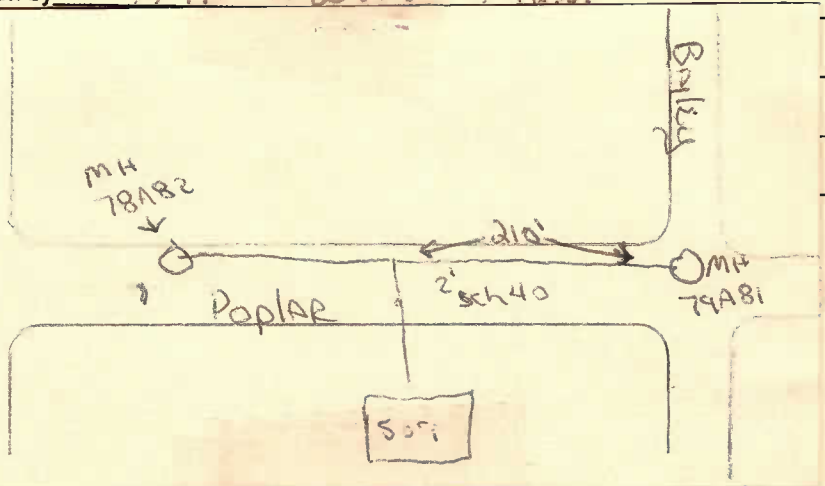

Fees: Connection Fee \$ _____

Receipt No. _____

Tap Charge \$ _____

Receipt No. _____

Inspection Fee \$ 0 N/C

Receipt No. N/C

Street Cut \$ _____

Receipt No. _____

APPLICANT

Signed [Signature]
☐ Plumbing Contractor
☐ General Contract
☐ Owner (Address _____)

Complete
1/15/15
WA

APPROVED
Jacksonville Wastewater Utility

By: [Signature] Date: 1/15/15