



No. 05-0224

JACKSONVILLE WASTEWATER UTILITY248 Cloverdale Road • P.O. Box 69
Jacksonville, AR 72078-0069
982-0581**RESIDENTIAL OR COMMERCIAL BUILDING SEWER CONNECTION PERMIT**Street Address 513 Forest Oak CoveLegal Description Lot # 26 Forest Oak Sub PH II

Facility to be connected to sewer:

Single Family Residence ☒ *Multi-family Residential _____ Units _____

*Commercial Installation _____ Description: _____

Water Meter (s) Size 5/8

* Commercial installations, and multi-family installations of more than 4 dwelling units must be accompanied by a site plan showing the proposed building sewer.

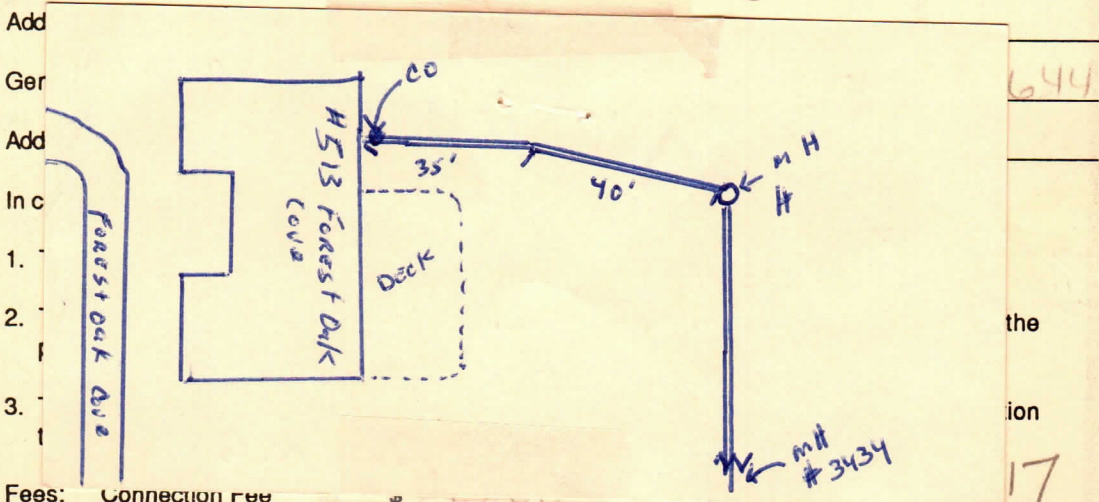
Sewer line installation by Westlake Plumbg.

Fees: Connection Fee \$ _____

Tap Charge \$ _____ Receipt No. _____

Inspection Fee \$ 12.00 Receipt No. 2146

Street Cut \$ _____ Receipt No. _____

APPLICANTSigned [Signature]☐ Plumbing Contractor☐ General Contract☐ Owner (Address _____)**APPROVED**

Jacksonville Wastewater Utility

By: [Signature] Date: 7-21-05