



**JACKSONVILLE WASTEWATER UTILITY**  
248 Cloverdale Rd.  
Jacksonville, AR 72076  
501-982-0581

No. 22- 0055

**RESIDENTIAL OR COMMERCIAL BUILDING SEWER CONNECTION PERMIT**

Street Address 515 S. Road

Legal Description \_\_\_\_\_

Facility to be connected to sewer:

Single Family Residence ☒ \*Multi-family Residential \_\_\_\_\_ Units \_\_\_\_\_

\*Commercial Installation \_\_\_\_\_ Description: Replacement

Water Meter (s) Size 5/8

\* Commercial installations, and multi-family installations of more than 4 dwelling units must be accompanied by a site plan showing the proposed building sewer.

Sewer line installation by Albert Schmidt/Humber Nick 515-4021

Address \_\_\_\_\_

General \_\_\_\_\_

Address \_\_\_\_\_

In consid \_\_\_\_\_

1. To ac \_\_\_\_\_

2. To m \_\_\_\_\_

3. To n \_\_\_\_\_

to the \_\_\_\_\_

Fee: Connection Fee \$ \_\_\_\_\_ Receipt No. \_\_\_\_\_

Tap Charge \$ \_\_\_\_\_ Receipt No. \_\_\_\_\_

Inspection Fee \$ 25.00 Receipt No. 802504

Street Cut \$ \_\_\_\_\_ Receipt No. \_\_\_\_\_

APPLICANT \_\_\_\_\_

Signed \_\_\_\_\_

☐ Plumbing Contractor

☐ General Contract

☐ Owner (Address \_\_\_\_\_)

APPROVED  
Jacksonville Wastewater Utility

By: \_\_\_\_\_ Date: \_\_\_\_\_

*Complete*  
*7/26/2022*





No. 22- 0031

**JACKSONVILLE WASTEWATER UTILITY**  
248 Cloverdale Rd.  
Jacksonville, AR 72076  
501-982-0581

**RESIDENTIAL OR COMMERCIAL BUILDING SEWER CONNECTION PERMIT**Street Address 515 S. ~~5th~~ RoadLegal Description Smith Road

Facility to be connected to sewer:

Single Family Residence ☒ \*Multi-family Residential \_\_\_\_\_ Units \_\_\_\_\_\*Commercial Installation \_\_\_\_\_ Description: Street cut

Water Meter (s) Size \_\_\_\_\_

\* Commercial installations, and multi-family installations of more than 4 dwelling units must be accompanied by a site plan showing the proposed building sewer.

Sewer line installation by Open Vacuos - 501-804-1065

Address 91860 0

General \_\_\_\_\_

Address \_\_\_\_\_

In cons \_\_\_\_\_

1. To a \_\_\_\_\_

2. To n \_\_\_\_\_  
pub \_\_\_\_\_

3. To r \_\_\_\_\_  
to th \_\_\_\_\_

South Road

20' SCH 40

515'

C.O.

ction

Fee: Connection Fee \$ \_\_\_\_\_ Receipt No. \_\_\_\_\_

Tap Charge \$ \_\_\_\_\_ Receipt No. \_\_\_\_\_

Inspection Fee \$ \_\_\_\_\_ Receipt No. 8Street Cut \$ 1050.00 Receipt No. 802 444APPLICANT Signed Gary Yagos

☐ Plumbing Contractor

☐ General Contract

☐ Owner (Address \_\_\_\_\_)

Complete  
5/18/2022

APPROVED  
Jacksonville Wastewater UtilityBy: [Signature] Date: 5/10/2022





**JACKSONVILLE WASTEWATER UTILITY**  
248 Cloverdale Rd.  
Jacksonville, AR 72076  
501-982-0581

No. 21-0081

**RESIDENTIAL OR COMMERCIAL BUILDING SEWER CONNECTION PERMIT**

Street Address 515 S. Board

Legal Description \_\_\_\_\_

Facility to be connected to sewer:

Single Family Residence ☒ \*Multi-family Residential \_\_\_\_\_ Units \_\_\_\_\_

\*Commercial Installation \_\_\_\_\_ Description: Repair

Water Meter (s) Size 5/8

\* Commercial installations, and multi-family installations of more than 4 dwelling units must be accompanied by a site plan showing the proposed building sewer.

Sewer line installation by JWUU-Roddy

Address ☒

General \_\_\_\_\_

Address \_\_\_\_\_

In consid \_\_\_\_\_

1. To acc \_\_\_\_\_

2. To ma  
public \_\_\_\_\_

3. To no  
to the \_\_\_\_\_

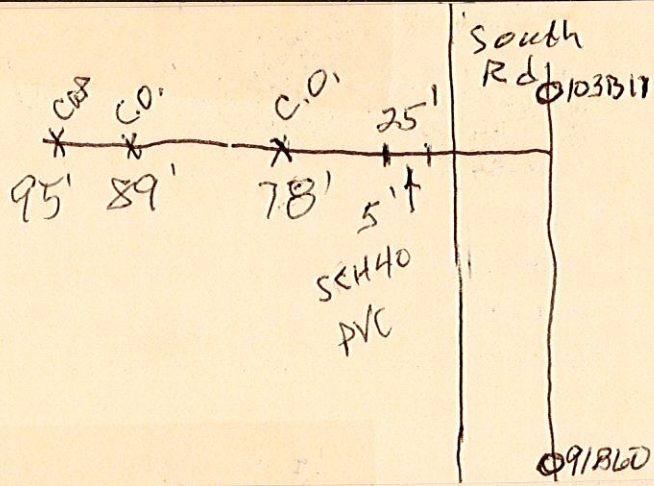

Fee: Connection Fee \$ \_\_\_\_\_ Receipt No. \_\_\_\_\_

Tap Charge \$ \_\_\_\_\_ Receipt No. \_\_\_\_\_

Inspection Fee \$ 0 Receipt No. no chg

Street Cut \$ \_\_\_\_\_ Receipt No. \_\_\_\_\_

APPLICANT

Signed on file

☐ Plumbing Contractor

☐ General Contract

☒ Owner (Address \_\_\_\_\_)

APPROVED  
Jacksonville Wastewater Utility

By: [Signature] Date: 10/13/21

Complete  
10/13/2021

