



No. 05-0144

JACKSONVILLE WASTEWATER UTILITY

248 Cloverdale Road • P.O. Box 69
Jacksonville, AR 72078-0069
982-0581

RESIDENTIAL OR COMMERCIAL BUILDING SEWER CONNECTION PERMIT

Street Address 5416 Ridge Rd

Legal Description Lot # 21 On Ridge

Facility to be connected to sewer:

Single Family Residence ☒ *Multi-family Residential _____ Units _____

*Commercial Installation _____ Description: _____

Water Meter (s) Size 1/2"

* Commercial installations, and multi-family installations of more than 4 dwelling units must be accompanied by a site plan showing the proposed building sewer.

Sewer line installation by Star Plumbing

Address _____

General Contractor _____

Address 110

In consideration

1. To accept ar
2. To maintain public sewer
3. To notify the to the public

Fees: Conne

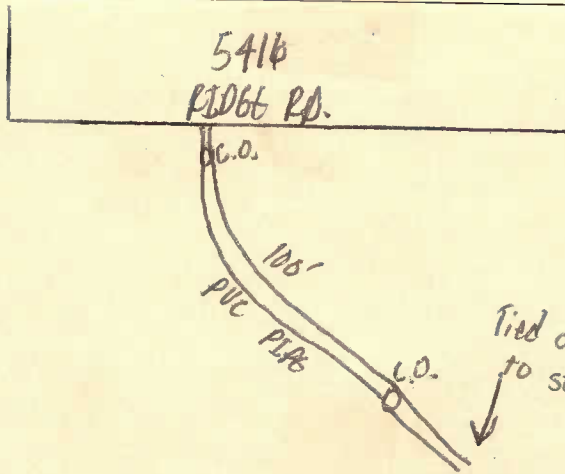

Tap Charge \$ _____

Receipt No. _____

Inspection Fee \$ 12.00

Receipt No. 2095

Street Cut \$ _____

Receipt No. _____

APPLICANT

Signed [Signature]

☐ Plumbing Contractor

☐ General Contract

☐ Owner (Address _____)

APPROVED

Jacksonville Wastewater Utility

By: [Signature] Date: 4-28-05