



JACKSONVILLE WASTEWATER UTILITY
248 Cloverdale Rd.
Jacksonville, AR 72076
501-982-0581

No. 10-0000249

RESIDENTIAL OR COMMERCIAL BUILDING SEWER CONNECTION PERMIT

Street Address 5709 Flight Court

Legal Description Lot 41 Base Meadows

Facility to be connected to sewer:

Single Family Residence _____ *Multi-family Residential _____ Units _____

*Commercial Installation _____ Description: New Connection

Water Meter (s) Size 3/8

* Commercial installations, and multi-family installations of more than 4 dwelling units must be accompanied by a site plan showing the proposed building sewer.

Sewer line installation by Mickey T. Cutwell 501-796-2048

Address _____

General Contractor _____

Address _____

In consideration of _____

1. To accept _____

2. To maintain public sewer _____

3. To notify the public _____

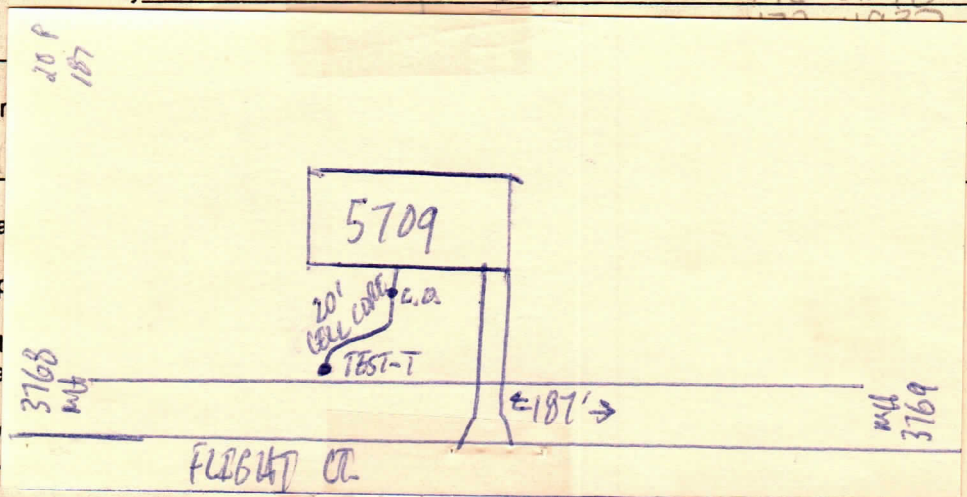

Fees: Connection Fee \$ 75.00 11/3/10 Receipt No. 241036

Tap Charge \$ _____ Receipt No. _____

Inspection Fee \$ 25.00 1/27/11 Receipt No. 241146

Street Cut \$ _____ Receipt No. _____

APPLICANT Signed [Signature]

- ☐ Plumbing Contractor
☐ General Contract
☐ Owner (Address _____)

Daugh
2/16

complete
2/16/11

APPROVED
Jacksonville Wastewater Utility

By: [Signature] Date: 10.25.10