



# JACKSONVILLE WASTEWATER UTILITY

248 Cloverdale Rd.  
Jacksonville, AR 72076  
501-982-0581

No. 07-0064

## RESIDENTIAL OR COMMERCIAL BUILDING SEWER CONNECTION PERMIT

Street Address 600 Neal St.

Legal Description \_\_\_\_\_

Facility to be connected to sewer:

Single Family Residence ☒ \*Multi-family Residential \_\_\_\_\_ Units \_\_\_\_\_

\*Commercial Installation \_\_\_\_\_ Description: Repair

Water Meter (s) Size 5/8"

\* Commercial installations, and multi-family installations of more than 4 dwelling units must be accompanied by a site plan showing the proposed building sewer.

Sewer line installation by AAA Plumbing

Address \_\_\_\_\_

General C \_\_\_\_\_

Address \_\_\_\_\_

In consid \_\_\_\_\_

1. To acc \_\_\_\_\_

2. To ma public \_\_\_\_\_

3. To not to the \_\_\_\_\_



### JACKSONVILLE WASTEWATER UTILITY SERVICE INSPECTION

PERMIT NO. 06-0064

DATE: 3-22-07

OWNER: \_\_\_\_\_

ADDRESS: 600 NEAL ST

PLUMBER: AAA PLUMBING

SERVICE LINE: OK ☒ REJECTED ☐ REASON: \_\_\_\_\_

SIGNED: Darryl Pickens

Fees: Connection Fee \$ \_\_\_\_\_

Receipt No. \_\_\_\_\_

Tap Charge \$ \_\_\_\_\_

Receipt No. \_\_\_\_\_

Inspection Fee \$ 12.00

Receipt No. on file

Street Cut \$ \_\_\_\_\_

Receipt No. \_\_\_\_\_

### APPLICANT

Signed Signature on File

☐ Plumbing Contractor

☐ General Contract

☐ Owner (Address \_\_\_\_\_)

### APPROVED

Jacksonville Wastewater Utility

By: Jessica Kendrick Date: 3-22-07

Inspected  
3-22-07



No. 09- 0166

JACKSONVILLE WASTEWATER UTILITY  
248 Cloverdale Rd.  
Jacksonville, AR 72076  
501-982-0581

RESIDENTIAL OR COMMERCIAL BUILDING SEWER CONNECTION PERMIT

Street Address 600 Neal

Legal Description \_\_\_\_\_

Facility to be connected to sewer:

Single Family Residence ☒ \*Multi-family Residential \_\_\_\_\_ Units \_\_\_\_\_\*Commercial Installation \_\_\_\_\_ Description: to placementWater Meter (s) Size 5/2

\* Commercial installations, and multi-family installations of more than 4 dwelling units must be accompanied by a site plan showing the proposed building sewer.

Sewer line installation by Arms Plumbing

Address \_\_\_\_\_

General Contractor \_\_\_\_\_

Address \_\_\_\_\_

In consideration of \_\_\_\_\_

1. To accept \_\_\_\_\_

2. To maintain public sewer \_\_\_\_\_

3. To notify \_\_\_\_\_ to the public \_\_\_\_\_

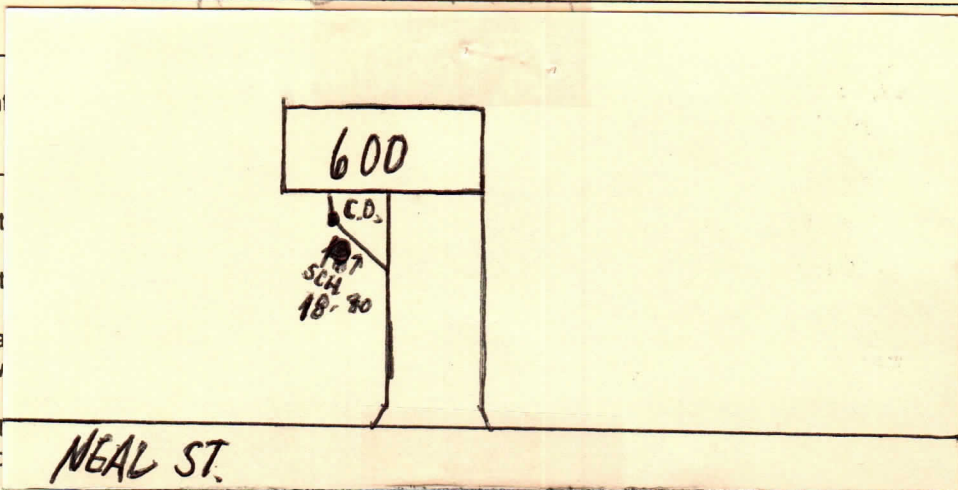

Fees: Connection Fee \$ \_\_\_\_\_ Receipt No. \_\_\_\_\_

Tap Charge \$ \_\_\_\_\_ Receipt No. \_\_\_\_\_

Inspection Fee \$ 2500 Receipt No. 102309Street Cut \$ \_\_\_\_\_ Receipt No. on file

APPLICANT

Signed on file☐ Plumbing Contractor☐ General Contractor☐ Owner (Address \_\_\_\_\_)

APPROVED

Jacksonville Wastewater Utility

By: Vickie Head Date: 9/23/09

Completed  
9/23/09





# JACKSONVILLE WASTEWATER UTILITY

248 Cloverdale Rd.  
Jacksonville, AR 72076  
501-982-0581

No. 13- 0073

## RESIDENTIAL OR COMMERCIAL BUILDING SEWER CONNECTION PERMIT

Street Address 600 Neal Street

Legal Description \_\_\_\_\_

Facility to be connected to sewer:

Single Family Residence \_\_\_\_\_ \*Multi-family Residential \_\_\_\_\_ Units \_\_\_\_\_

\*Commercial Installation \_\_\_\_\_ Description: Repair

Water Meter (s) Size \_\_\_\_\_

\* Commercial installations, and multi-family installations of more than 4 dwelling units must be accompanied by a site plan showing the proposed building sewer.

Sewer line installation by Arrow Plumbing

Address 600 Neal St

General Repair

Address ties to m# 4 732

In consid \_\_\_\_\_

1. To ac \_\_\_\_\_

2. To m public \_\_\_\_\_

3. To no to the \_\_\_\_\_

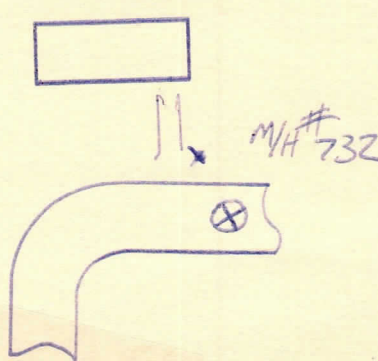

Fees: Connection Fee \$ \_\_\_\_\_

Receipt No. \_\_\_\_\_

Tap Charge \$ \_\_\_\_\_

Receipt No. \_\_\_\_\_

Inspection Fee \$ 25.00

Receipt No. on acct

Street Cut \$ \_\_\_\_\_

Receipt No. \_\_\_\_\_

### APPLICANT

Signed by phone - on file

☐ Plumbing Contractor

☐ General Contract

☐ Owner (Address \_\_\_\_\_)

### APPROVED

Jacksonville Wastewater Utility

By: Patricia Keel Date: 3/19/13

*Complete  
3/20/13*