



No. 05-0223

JACKSONVILLE WASTEWATER UTILITY248 Cloverdale Road · P.O. Box 69
Jacksonville, AR 72078-0069
982-0581**RESIDENTIAL OR COMMERCIAL BUILDING SEWER CONNECTION PERMIT**Street Address 6008 Flight CourtLegal Description Lot 55 Base Meadow

Facility to be connected to sewer:

Single Family Residence X *Multi-family Residential _____ Units _____

*Commercial Installation _____ Description: _____

Water Meter (s) Size _____

* Commercial installations, and multi-family installations of more than 4 dwelling units must be accompanied by a site plan showing the proposed building sewer.

Sewer line installation by John Martin

Address _____

General _____

Address _____

In cons _____

1. To a _____

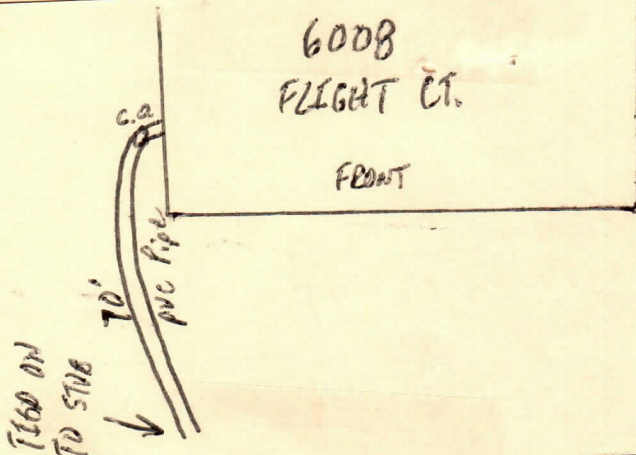
2. To n
publi _____3. To n
to the _____Fees: Connection Fee \$ 15.00Receipt No. 2103

Tap Charge \$ _____

Receipt No. _____

Inspection Fee \$ 12.00Receipt No. 2160

Street Cut \$ _____

Receipt No. 11-02-65**APPLICANT**Signed Roy Treas☐ Plumbing Contractor☐ General Contract☐ Owner (Address _____)**APPROVED**

Jacksonville Wastewater Utility

By: [Signature] Date: 9-20-05

Darryl

Inspected 2/7/06