



JACKSONVILLE WASTEWATER UTILITY

0150

RESIDENTIAL OR COMMERCIAL BUILDING SEWER CONNECTION PERMIT

Street Address 613 SPRING ST

Legal Description Lot 10 Heatherwood

Facility to be connected to sewer:

Single Family Residence _____ * Multi-family Residential ✓ Units 2

* Commercial Installation _____ Description: New (one or two units)

Water Meter (s) size 3/4

* Commerical installations, and multi-family installations of more than 4 dwelling units must be accompanied by a site plan showing the proposed building sewer.

Sewer line installation by STEVE BIRKSHIRE

Address _____

General C

Address

In consid

1. To acc

2. To ma
conn

3. To no
and c
cover

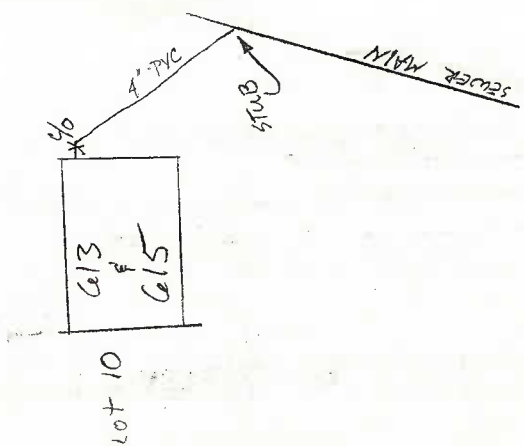

Fees:

Tap Charge \$ _____

Receipt no. _____

Inspection Fee \$ 600

Receipt No. 1677 4-22-85

Total Fees \$ _____

APPLICANT

Signed [Signature]

- ☐ Plumbing Contractor
- ☐ General Contract
- ☐ Owner (Address _____)

APPROVED
Jacksonville Wastewater Utility

By: Kathy L. Feltz Date: 4-22-85



JACKSONVILLE WASTEWATER UTILITY

0151

RESIDENTIAL OR COMMERCIAL BUILDING SEWER CONNECTION PERMIT

Street Address C15 SPRING ST

Legal Description Lot 10 Heatherwood

Facility to be connected to sewer:

Single Family Residence _____ *Multi-family Residential ✓ Units 2

*Commercial Installation _____ Description: House (one of two units)

Water Meter (s) size 3/4

*Commerical installations, and multi-family installations of more than 4 dwelling units must be accompanied by a site plan showing the proposed building sewer.

Sewer line installation by STEVE BIRKSHIRE

Address _____

General Contractor _____

Address _____

In consideration of:

1. To accept
2. To maintain and connect
3. To notify and cover.

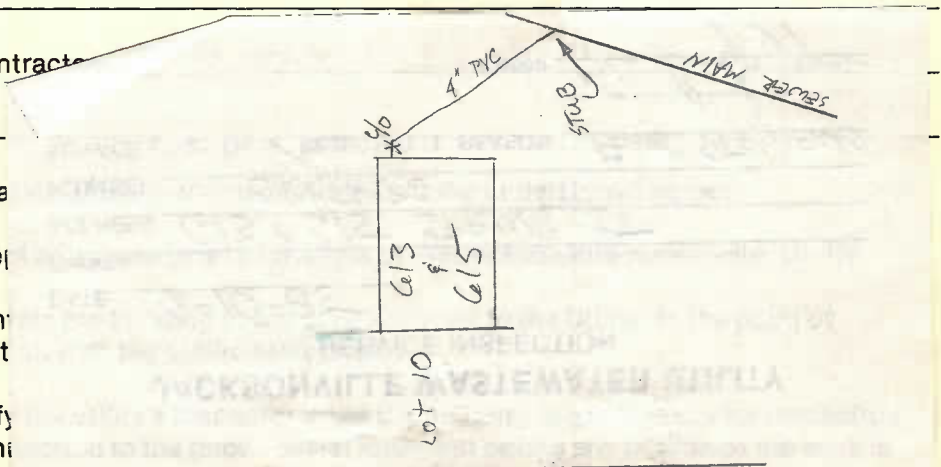

Fees:	Connection fee	\$ _____	Receipt No. <u>16774-23-85</u>
	Tap Charge	\$ _____	Receipt No. _____
	Inspection Fee	\$ <u>6.00</u>	Receipt No. <u>16774-23-85</u>
	Total Fees	\$ _____	

APPLICANT

Signed [Signature]

- ☐ Plumbing Contractor
☐ General Contractor
☐ Owner (Address _____)

APPROVED
Jacksonville Wastewater Utility

By: Patty L. Fields Date: 4-23-85