



No. 96- 018

JACKSONVILLE WASTEWATER UTILITY

248 Cloverdale Road • P.O. Box 69
Jacksonville, AR 72078-0069
982-0581

RESIDENTIAL OR COMMERCIAL BUILDING SEWER CONNECTION PERMITStreet Address 617 Hill

Legal Description _____

Facility to be connected to sewer:

Single Family Residence ☒ *Multi-family Residential _____ Units _____*Commercial Installation _____ Description: repairWater Meter (s) Size 5/8

* Commercial installations, and multi-family installations of more than 4 dwelling units must be accompanied by a site plan showing the proposed building sewer.

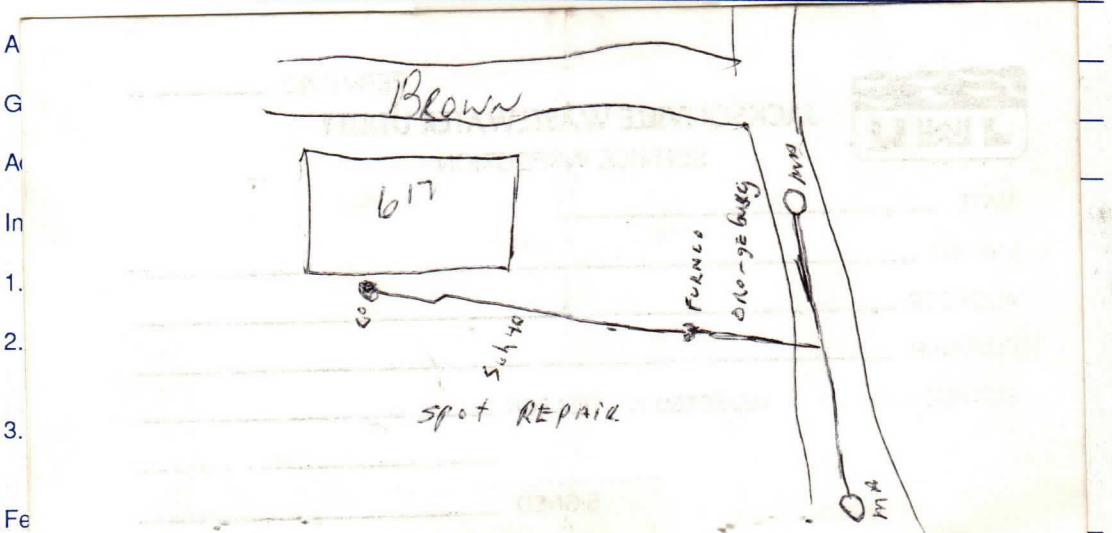
Sewer line installation by Bill Wheaton

Tap Charge \$ _____

Receipt No. _____

Inspection Fee \$ 6.00Receipt No. 5354

Total Fees \$ _____

APPLICANTSigned [Signature]☐ Plumbing Contractor☐ General Contract☒ Owner (Address _____)**APPROVED**

Jacksonville Wastewater Utility

By: Dana Duncan Date: 2-29-96