

No. 89- 030

JACKSONVILLE WASTEWATER UTILITY

RESIDENTIAL OR COMMERCIAL BUILDING SEWER CONNECTION PERMIT

Street Address 620 Chance Cove NewLegal Description Lot 355

Facility to be connected to sewer:

Single Family Residence ☒ *Multi-family Residential _____ Units _____

*Commercial Installation _____ Description: _____

Water Meter (s) size 5/8"

*Commercal installations, and multi-family installations of more than 4 dwelling units must be accompanied by a site plan showing the proposed building sewer.

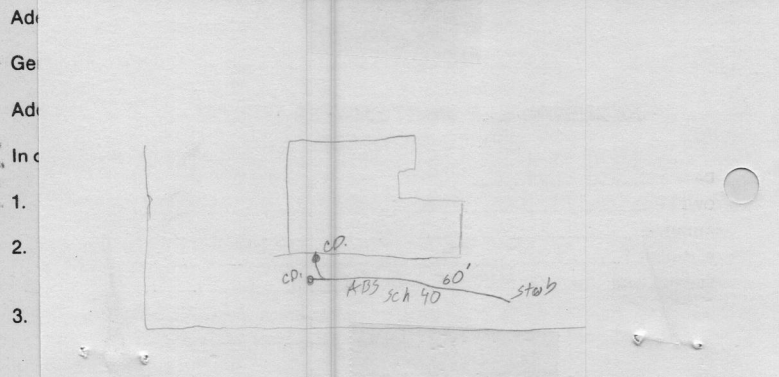
Sewer line installation by BrittainFees: Connection Fee \$ 75.00Receipt No. 546 3-24-89

Tap Charge \$ _____

Receipt No. _____

Inspection Fee \$ 16.00Receipt No. 607 5-3-89Total Fees \$ 81.00

APPLICANT

Signed Benny Buldrige☐ Plumbing Contractor☐ General Contract☐ Owner (Address _____)

APPROVED

Jacksonville Wastewater Utility

By: Alia HughesDate: 5-3-89