



JACKSONVILLE WASTEWATER UTILITY
248 Cloverdale Rd.
Jacksonville, AR 72076
501-982-0581

No. 06- 0167

RESIDENTIAL OR COMMERCIAL BUILDING SEWER CONNECTION PERMIT

Street Address 620 S. 1st Street

Legal Description _____

Facility to be connected to sewer:

Single Family Residence _____ *Multi-family Residential _____ Units _____

*Commercial Installation ☒ Description: Sand Trap

Water Meter (s) Size _____

* Commercial installations, and multi-family installations of more than 4 dwelling units must be accompanied by a site plan showing the proposed building sewer.

Sewer line installation by Bordueaux Plumbing - MP21615

Address 631710

General Contractor Parlman

Address _____

In consideration of the granting of this permit the

1. To accept and abide by all provisions of the
2. To maintain the building sewer at no expense to the public sewer main.
3. To notify the utility's inspector when the building sewer is connected to the public sewer main, but before any portion of the building is occupied.

Fees: Connection Fee \$ _____
Tap Charge \$ _____
Inspection Fee \$ 12.00
Street Cut \$ _____

APPLICANT ☒ Owner
Signed _____
☐ Plumbing Contractor
☐ General Contractor
☐ Owner (Address _____)

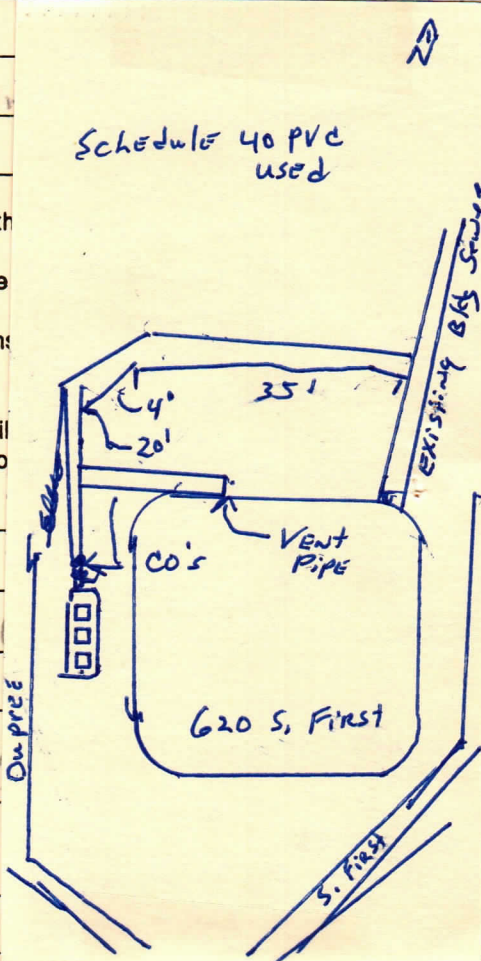

APPROVED
Jacksonville Wastewater Utility

By: Jessica Kendrick Date: 6-16-06

John Inspected 6-19-06