

No. 89- 040

## JACKSONVILLE WASTEWATER UTILITY

## RESIDENTIAL OR COMMERCIAL BUILDING SEWER CONNECTION PERMIT

Street Address 621 NorthavenLegal Description Lot 386 Stonewall

Facility to be connected to sewer:

Single Family Residence ☒ \*Multi-family Residential \_\_\_\_\_ Units \_\_\_\_\_\*Commercial Installation \_\_\_\_\_ Description: NewWater Meter (s) size 5/8"

\*Commerical installations, and multi-family installations of more than 4 dwelling units must be accompanied by a site plan showing the proposed building sewer.

Sewer line installation by Britt's

Add

Ger

Add

In c

1.

2.

3.

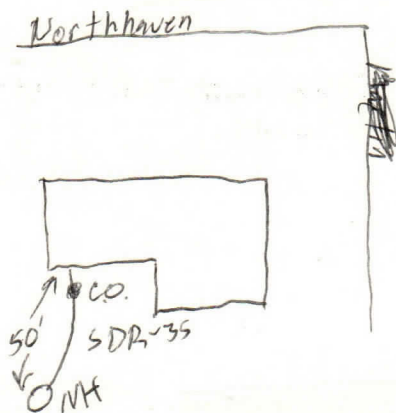

Fees: Connection Fee \$ 75.00  
Tap Charge \$ \_\_\_\_\_  
Inspection Fee \$ 6.00  
Total Fees \$ 81.00

Receipt No. 578 4-17-89  
Receipt No. \_\_\_\_\_  
Receipt No. 606 5-3-89

## APPLICANT

Signed Jane M. Dink

- ☐ Plumbing Contractor  
☐ General Contract  
☐ Owner (Address \_\_\_\_\_)

## APPROVED

Jacksonville Wastewater Utility

By: Idea HughesDate: 5-31-89