



No. 88-00011

JACKSONVILLE WASTEWATER UTILITY

RESIDENTIAL OR COMMERCIAL BUILDING SEWER CONNECTION PERMIT

Street Address 7 Club Road

Legal Description _____

Facility to be connected to sewer:

Single Family Residence * Multi-family Residential Units

* Commercial Installation Description: replacement

Water Meter (s) size

* Commerical installations, and multi-family installations of more than 4 dwelling units must be accompanied by a site plan showing the proposed building sewer.

Sewer line installation by Hardin PBC

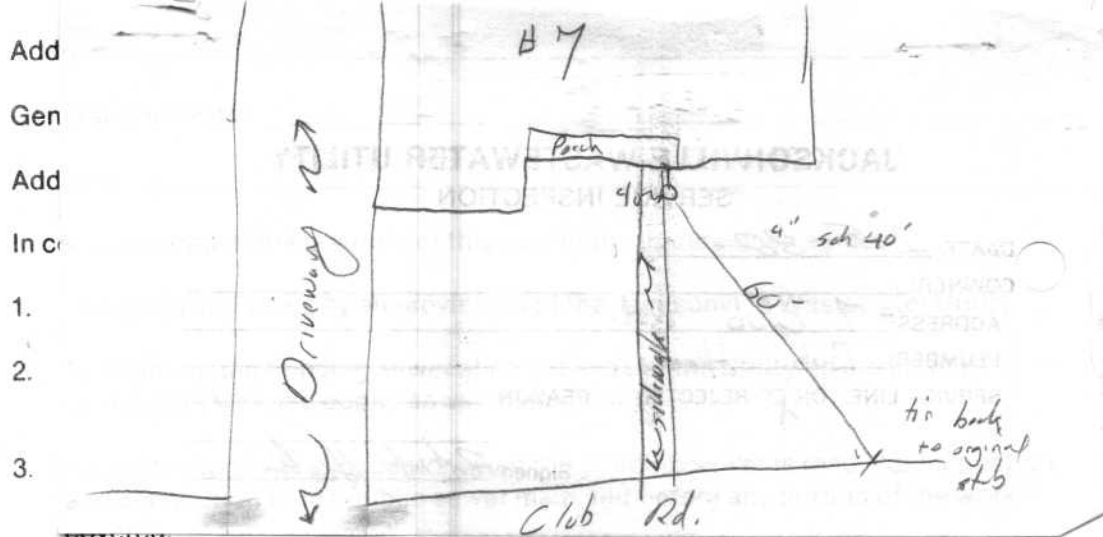

Fees: Connection Fee \$ _____
Tap Charge \$ _____
Inspection Fee \$ 1.00
Total Fees \$ 1.00

Receipt No. _____

Receipt No. _____

Receipt No. 3121 ✓ SKV

APPLICANT Signed Robert Hard

- ☒ Plumbing Contractor
☐ General Contract
☐ Owner (Address _____)

APPROVED
Jacksonville Wastewater Utility

By: 2/5/84

Date: 2/5/84



No. 93-068

JACKSONVILLE WASTEWATER UTILITY

248 Cloverdale Road • P.O. Box 69
Jacksonville, AR 72076
982-0581

RESIDENTIAL OR COMMERCIAL BUILDING SEWER CONNECTION PERMIT

Street Address # 7 Club CourtLegal Description Lot 319 Foxwood Sub Ph VIII

Facility to be connected to sewer:

Single Family Residence ☒ *Multi-family Residential _____ Units _____

*Commercial Installation _____ Description: _____

Water Meter (s) Size 5/8

* Commercial installations, and multi-family installations of more than 4 dwelling units must be accompanied by a site plan showing the proposed building sewer.

Sewer line installation by Circle M

Address _____

Gener _____

Address _____

In con _____

1. To _____

2. To
put _____3. To
to t _____

Fees: _____

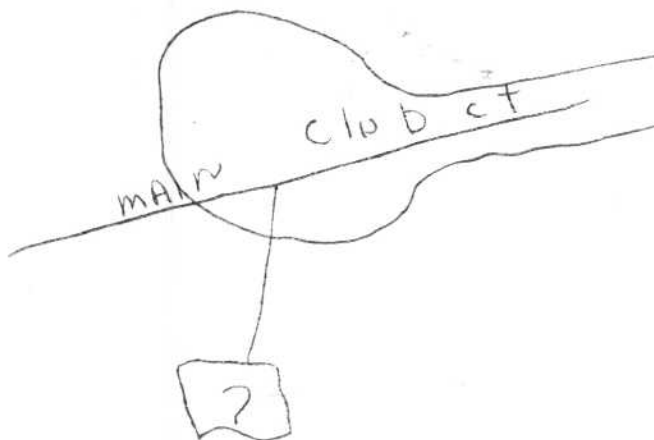

Tap Charge \$ _____

Receipt No. _____

Inspection Fee \$ 6.00Receipt No. 1534Total Fees \$ 75.00

APPLICANT

Signed [Signature]☐ Plumbing Contractor☐ General Contract☐ Owner (Address _____)

APPROVED

Jacksonville Wastewater Utility

By: Lee LeonardDate: 6-28-93



JACKSONVILLE WASTEWATER UTILITY

248 Cloverdale Rd.
Jacksonville, AR 72076
501-982-0581

No. 17-071

RESIDENTIAL OR COMMERCIAL BUILDING SEWER CONNECTION PERMIT

Street Address 7 Club Road

Legal Description _____

Facility to be connected to sewer:

Single Family Residence ☒ *Multi-family Residential _____ Units _____

*Commercial Installation _____ Description: Repair - reroute

Water Meter (s) Size 5/8"

* Commercial installations, and multi-family installations of more than 4 dwelling units must be accompanied by a site plan showing the proposed building sewer.

Sewer line installation by Sanders Plumbing John McDermott 374 0117 5156

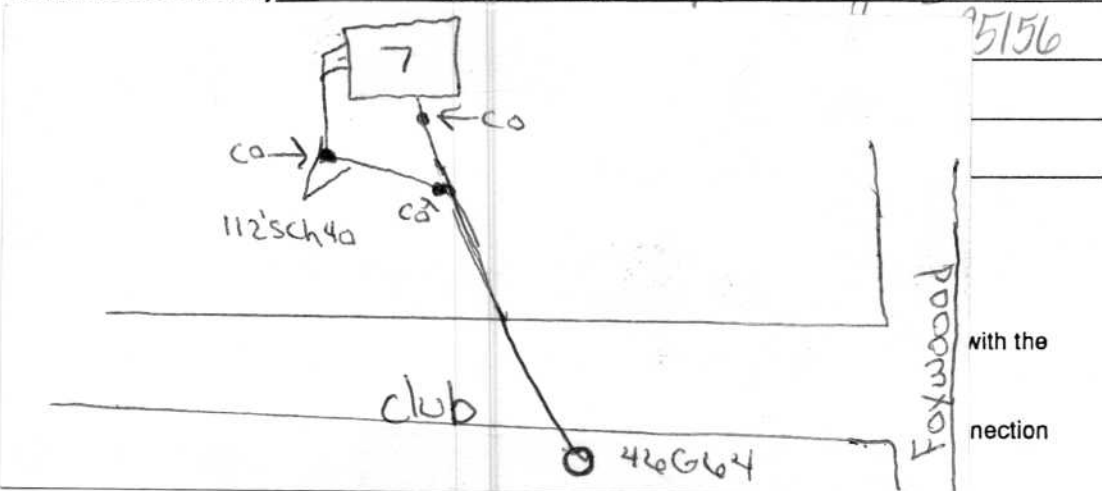

Fees:	Connection Fee	\$ _____	Receipt No. _____
	Tap Charge	\$ _____	Receipt No. _____
	Inspection Fee	\$ <u>25.00</u>	Receipt No. <u>174174</u>
	Street Cut	\$ _____	Receipt No. _____

APPLICANT
Signed John McDermott
☒ Plumbing Contractor
☐ General Contract
☐ Owner (Address _____)

APPROVED
Jacksonville Wastewater Utility

By: Jessica Kendrick Date: 4-12-17