



JACKSONVILLE WASTEWATER UTILITY

248 Cloverdale Rd.
Jacksonville, AR 72076
501-982-0581

No. 17-056

RESIDENTIAL OR COMMERCIAL BUILDING SEWER CONNECTION PERMIT

Street Address 7000 161 Hwy 1

Legal Description _____

Facility to be connected to sewer:

Single Family Residence ☒ *Multi-family Residential _____ Units _____

*Commercial Installation _____ Description: Spot repair

Water Meter (s) Size 5/8

* Commercial installations, and multi-family installations of more than 4 dwelling units must be accompanied by a site plan showing the proposed building sewer.

Sewer line installation by Twine-Lee

Address _____

General _____

Address _____

In construction _____

1. To _____

2. To _____
public

3. To _____
to the

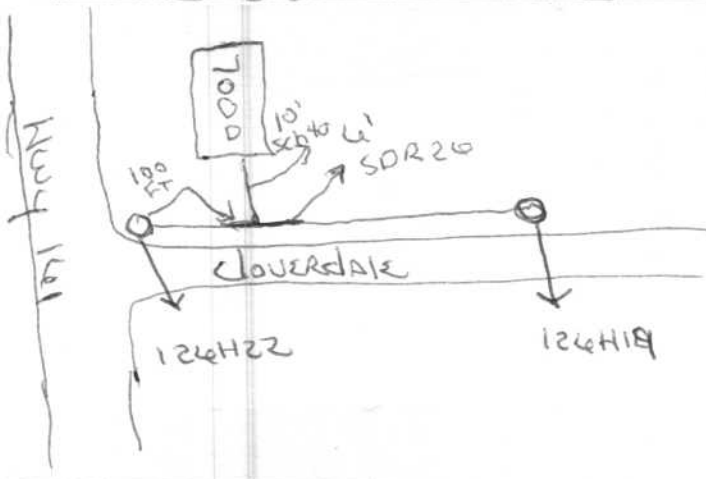

Fees: Connection Fee \$ _____ Receipt No. _____

Tap Charge \$ _____ Receipt No. _____

Inspection Fee \$ 0 Receipt No. no chg

Street Cut \$ _____ Receipt No. _____

APPLICANT
Signed on file

☐ Plumbing Contractor

☐ General Contract

☐ Owner (Address _____)

David M.

APPROVED
Jacksonville Wastewater Utility

By: Robin Deal Date: 3/21/17

Complete
3/21/17
WA