

JACKSONVILLE WASTEWATER UTILITY

No 500

RESIDENTIAL OR COMMERCIAL BUILDING SEWER CONNECTION PERMIT

Street Address 704 Briar Ridge Court

Legal Description Lot 142 Woodhewer Subdivision

Facility to be connected to sewer:

Single Family Residence ☒ *Multi-family Residential ☐ Units ☐

*Commercial Installation ☐ Description: New

Water Meter (s) size 5/8"

*Commerical installations, and multi-family installations of more than 4 dwelling units must be accompanied by a site plan showing the proposed building sewer.

Sewer line installation by Lot 142 Hardin P/L Co.

Address _____

General _____

Address _____

In consideration _____

1. To _____

2. To _____
con _____

3. To _____
and _____
cover _____

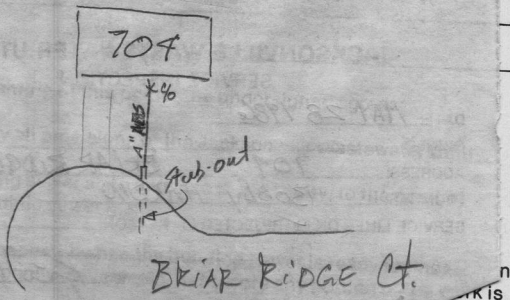

Fees: Connection Fee \$ 15.00
Tap Charge \$ _____
Inspection Fee \$ 6.00
Total Fees \$ 81.00

Receipt No. 3225 4/1/16
Receipt No. _____
Receipt No. 2304 5/28/16

APPLICANT

Signed Kathleen Simon

- ☐ Plumbing Contractor
☐ General Contract
☐ Owner (Address _____)

APPROVED

Jacksonville Wastewater Utility

By: Melissa J. Selles Date: 5/28/16