



No. 01252

## JACKSONVILLE WASTEWATER UTILITY

248 Cloverdale Road · P.O. Box 69  
Jacksonville, AR 72078-0069  
982-0581

## RESIDENTIAL OR COMMERCIAL BUILDING SEWER CONNECTION PERMIT

Street Address 708 Lenora

Legal Description \_\_\_\_\_

Facility to be connected to sewer:

Single Family Residence ☒ \*Multi-family Residential \_\_\_\_\_ Units \_\_\_\_\_\*Commercial Installation \_\_\_\_\_ Description: ReplacementWater Meter (s) Size 5/8

\* Commercial installations, and multi-family installations of more than 4 dwelling units must be accompanied by a site plan showing the proposed building sewer.

Sewer line installation by Run's Express Plumbing

Ad

Ge

Ad

In

1.

2.

3.

Fe

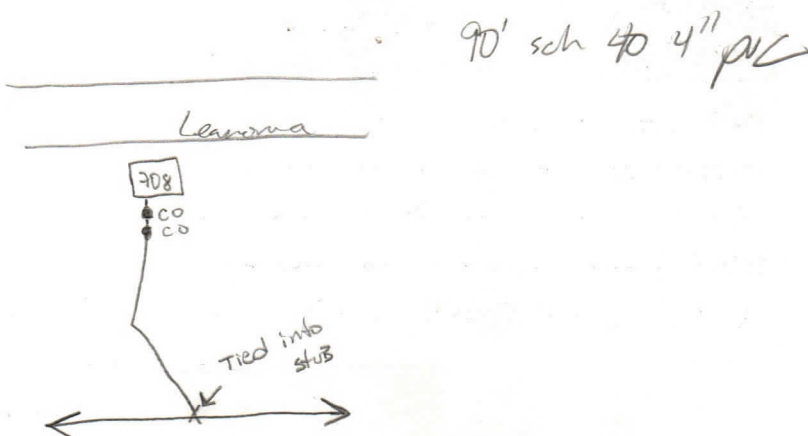

Tap Charge \$ \_\_\_\_\_

Receipt No. \_\_\_\_\_

Inspection Fee \$ 6.00Receipt No. 5066Total Fees \$ 6.00

## APPLICANT

Signed \_\_\_\_\_

☐ Plumbing Contractor☐ General Contract☐ Owner (Address \_\_\_\_\_)

## APPROVED

Jacksonville Wastewater Utility

By: [Signature] Date: Oct 23, 01