



No. 05-0107

JACKSONVILLE WASTEWATER UTILITY

248 Cloverdale Road · P.O. Box 69
Jacksonville, AR 72078-0069
982-0581

RESIDENTIAL OR COMMERCIAL BUILDING SEWER CONNECTION PERMIT

Street Address 7100 Northlake Drive

Legal Description Lot # 368 Northlake Ph. II

Facility to be connected to sewer:

Single Family Residence ☒ *Multi-family Residential _____ Units _____

*Commercial Installation _____ Description: _____

Water Meter (s) Size 5/8"

* Commercial installations, and multi-family installations of more than 4 dwelling units must be accompanied by a site plan showing the proposed building sewer.

Sewer line installation by A & B Plumbing

Address _____

General Contractor Maxwell Ross Constr.

Address 3500 TR White Dr., Jax., AR 72076

In consideration of:

1. To a
2. To m
publi
3. To n
to the

Fees:

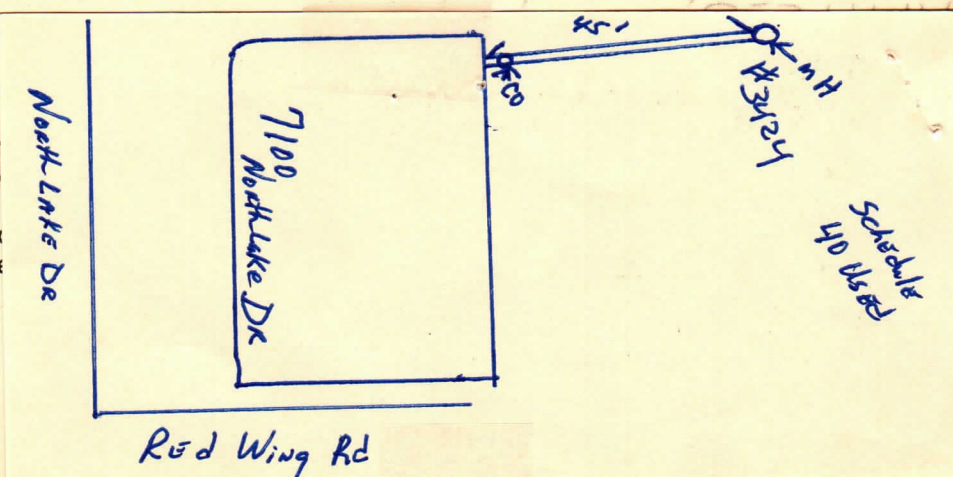

Street Cut \$ _____

Receipt No. _____

APPLICANT

Signed _____

- ☐ Plumbing Contractor
☐ General Contract
☐ Owner (Address _____)

APPROVED

Jacksonville Wastewater Utility

By: Lawrence Shust Date: 1-25-05