



No. 04- 0056

JACKSONVILLE WASTEWATER UTILITY248 Cloverdale Road • P.O. Box 69
Jacksonville, AR 72078-0069
982-0581**RESIDENTIAL OR COMMERCIAL BUILDING SEWER CONNECTION PERMIT**Street Address 7106 Northlake Dr. Lot # 371Legal Description Lot # 371 Northlake Sub.

Facility to be connected to sewer:

Single Family Residence ☒ *Multi-family Residential _____ Units _____

*Commercial Installation _____ Description: _____

Water Meter (s) Size 5/8

* Commercial installations, and multi-family installations of more than 4 dwelling units must be accompanied by a site plan showing the proposed building sewer.

Sewer line installation by Monroeth PlumbingAddress Lonoke County PlumbingGeneral Contractor Northlake Dr.Address 371

In consideration of:

1. To accept

2. To maintain public sewer

3. To notify to the public

Fees: Cor

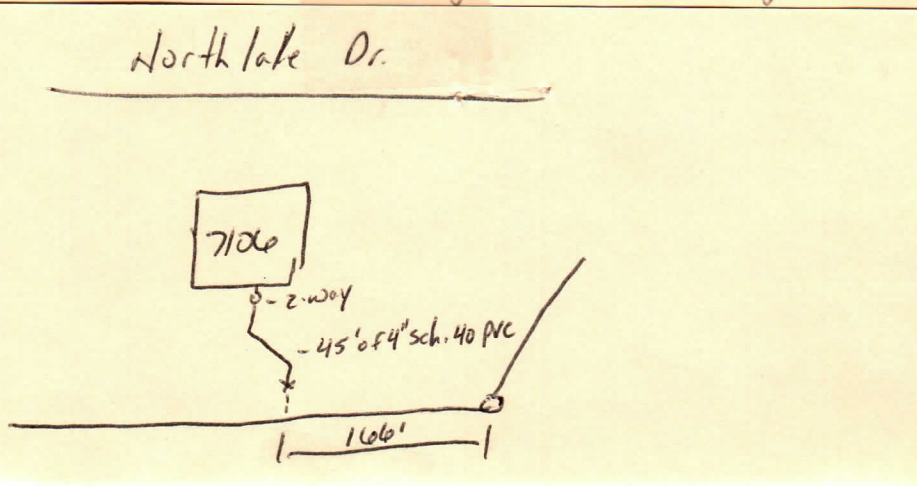

Tap Charge \$ _____

Receipt No. _____

Inspection Fee \$ 6.00Receipt No. 88041

Street Cut \$ _____

Receipt No. _____

APPLICANTSigned [Signature]☐ Plumbing Contractor☐ General Contractor☐ Owner (Address _____)**APPROVED**

Jacksonville Wastewater Utility

By: [Signature] Date: 5-3-04