



No. 05-0130

# JACKSONVILLE WASTEWATER UTILITY

248 Cloverdale Road • P.O. Box 69  
Jacksonville, AR 72078-0069  
982-0581

**RESIDENTIAL OR COMMERCIAL BUILDING SEWER CONNECTION PERMIT**

Street Address 111 Northlake Dr.

Legal Description lot 393 Northlake PH X-A

Facility to be connected to sewer:

Single Family Residence ✓ \*Multi-family Residential \_\_\_\_\_ Units

\*Commercial Installation \_\_\_\_\_ Description: \_\_\_\_\_

Water Meter (s) Size 3/8

\* Commercial installations, and multi-family installations of more than 4 dwelling units must be accompanied by a site plan showing the proposed building sewer.

Sewer line installation by J.W. Plumbing

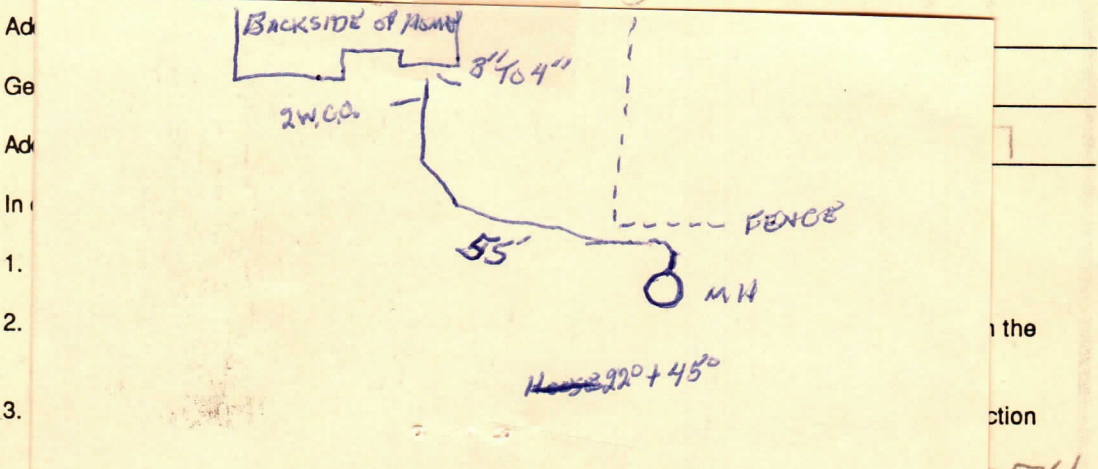

Fees: Connection Fee \$ 150

Receipt no. 157

Tap Charge \$ \_\_\_\_\_

Receipt No.

Inspection Fee \$ 12.00

Receipt No. 9079A.

Street Cut \$

Receipt No. \_\_\_\_\_

APPLICANT  
Signed Walter J. Gordon

- ☐ Plumbing Contractor  
☐ General Contract  
☐ Owner (Address \_\_\_\_\_)

**APPROVED**  
**Jacksonville Wastewater Utility**

By: John D. Smith Date: 4/15/05