



No. 92 - 0145

# JACKSONVILLE WASTEWATER UTILITY

248 Cloverdale Road • P.O. Box 69  
Jacksonville, AR 72076  
982-0581

## RESIDENTIAL OR COMMERCIAL BUILDING SEWER CONNECTION PERMIT

Street Address 717 Deal Street

Legal Description \_\_\_\_\_

Facility to be connected to sewer:

Single Family Residence \_\_\_\_\_ \*Multi-family Residential \_\_\_\_\_ Units \_\_\_\_\_

\*Commercial Installation \_\_\_\_\_ Description: Replacement

Water Meter (s) Size \_\_\_\_\_

\* Commercial installations, and multi-family installations of more than 4 dwelling units must be accompanied by a site plan showing the proposed building sewer.

Sewer line installation by Thomas Mitchell

Address \_\_\_\_\_

General \_\_\_\_\_

Address \_\_\_\_\_

In connection \_\_\_\_\_

1. To \_\_\_\_\_

2. To \_\_\_\_\_

3. To \_\_\_\_\_

to \_\_\_\_\_

Fees \_\_\_\_\_

Tap Charge \$ \_\_\_\_\_

Receipt No. \_\_\_\_\_

Inspection Fee \$ 6.00

Receipt No. 92-420 11/16

Total Fees \$ 6.00

APPLICANT  
Signed Pat Mitchell

☐ Plumbing Contractor

☐ General Contract

☒ Owner (Address See Above)

APPROVED

Jacksonville Wastewater Utility

By: Steven Richard Date: 11/16/92



# JACKSONVILLE WASTEWATER UTILITY

248 Cloverdale Road • P.O. Box 69  
Jacksonville, AR 72078-0069  
982-0581

No. 04- 0092

## RESIDENTIAL OR COMMERCIAL BUILDING SEWER CONNECTION PERMIT

Street Address 717 Neal Street

Legal Description \_\_\_\_\_

Facility to be connected to sewer:

Single Family Residence \_\_\_\_\_ \*Multi-family Residential \_\_\_\_\_ Units \_\_\_\_\_

\*Commercial Installation \_\_\_\_\_ Description: Street Cut

Water Meter (s) Size \_\_\_\_\_

\* Commercial installations, and multi-family installations of more than 4 dwelling units must be accompanied by a site plan showing the proposed building sewer.

Sewer line installation by AAA Plumbing Shop

Address 44' of 4" sch. 40 PVC.

General \_\_\_\_\_

Address \_\_\_\_\_

In construction \_\_\_\_\_

1. To a \_\_\_\_\_

2. To a public \_\_\_\_\_

3. To a \_\_\_\_\_ to the \_\_\_\_\_

Fees: Connection Fee \$ \_\_\_\_\_ Receipt No. \_\_\_\_\_

Tap Charge \$ \_\_\_\_\_ Receipt No. \_\_\_\_\_

Inspection Fee \$ \_\_\_\_\_ Receipt No. \_\_\_\_\_

Street Cut \$ 350.00 Receipt No. 2092

### APPLICANT

Signed on file

☐ Plumbing Contractor

☐ General Contract

☐ Owner (Address \_\_\_\_\_)

APPROVED  
Jacksonville Wastewater Utility

By: Carl Gordon Date: 20 February 2001





No. 04- 0094

**JACKSONVILLE WASTEWATER UTILITY**248 Cloverdale Road • P.O. Box 69  
Jacksonville, AR 72078-0069  
982-0581**RESIDENTIAL OR COMMERCIAL BUILDING SEWER CONNECTION PERMIT**Street Address 717 Neal Street

Legal Description \_\_\_\_\_

Facility to be connected to sewer:

Single Family Residence ☒ \*Multi-family Residential \_\_\_\_\_ Units \_\_\_\_\_\*Commercial Installation \_\_\_\_\_ Description: Street Cut

Water Meter (s) Size \_\_\_\_\_

\* Commercial installations, and multi-family installations of more than 4 dwelling units must be accompanied by a site plan showing the proposed building sewer.

Sewer line installation by Jacksonville Wastewater Utility

Address \_\_\_\_\_

General \_\_\_\_\_

Address \_\_\_\_\_

In consideration of \_\_\_\_\_

1. To acquire \_\_\_\_\_

2. To maintain \_\_\_\_\_ public \_\_\_\_\_

3. To not \_\_\_\_\_ to the \_\_\_\_\_

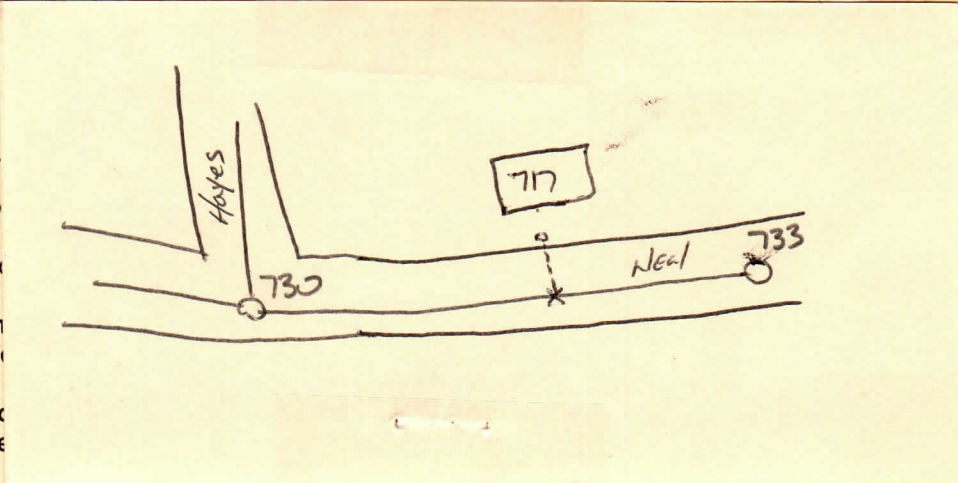

Fees: Connection Fee \$ \_\_\_\_\_ Receipt No. \_\_\_\_\_

Tap Charge \$ \_\_\_\_\_ Receipt No. \_\_\_\_\_

Inspection Fee \$ \_\_\_\_\_ Receipt No. \_\_\_\_\_

Street Cut \$ \_\_\_\_\_ Receipt No. \_\_\_\_\_

**APPLICANT**

Signed \_\_\_\_\_

☐ Plumbing Contractor☐ General Contract☐ Owner (Address \_\_\_\_\_)**APPROVED**

Jacksonville Wastewater Utility

By: Karl Gordon Date: 3 March 2004