



JACKSONVILLE WASTEWATER UTILITY  
248 Cloverdale Rd.  
Jacksonville, AR 72076  
501-982-0581

No. 14- 0165

RESIDENTIAL OR COMMERCIAL BUILDING SEWER CONNECTION PERMIT

Street Address 805 Harpole

Legal Description \_\_\_\_\_

Facility to be connected to sewer: ✓

Single Family Residence \_\_\_\_\_ \*Multi-family Residential \_\_\_\_\_ Units \_\_\_\_\_

\*Commercial Installation \_\_\_\_\_ Description: Street Cut

Water Meter (s) Size 5/8 Replacement Sanders Plumbing

\* Commercial installations, and multi-family installations of more than 4 dwelling units must be accompanied by a site plan showing the proposed building sewer. Phone 765-0098

Sewer line installation by Sanders Plumbing 376-3066

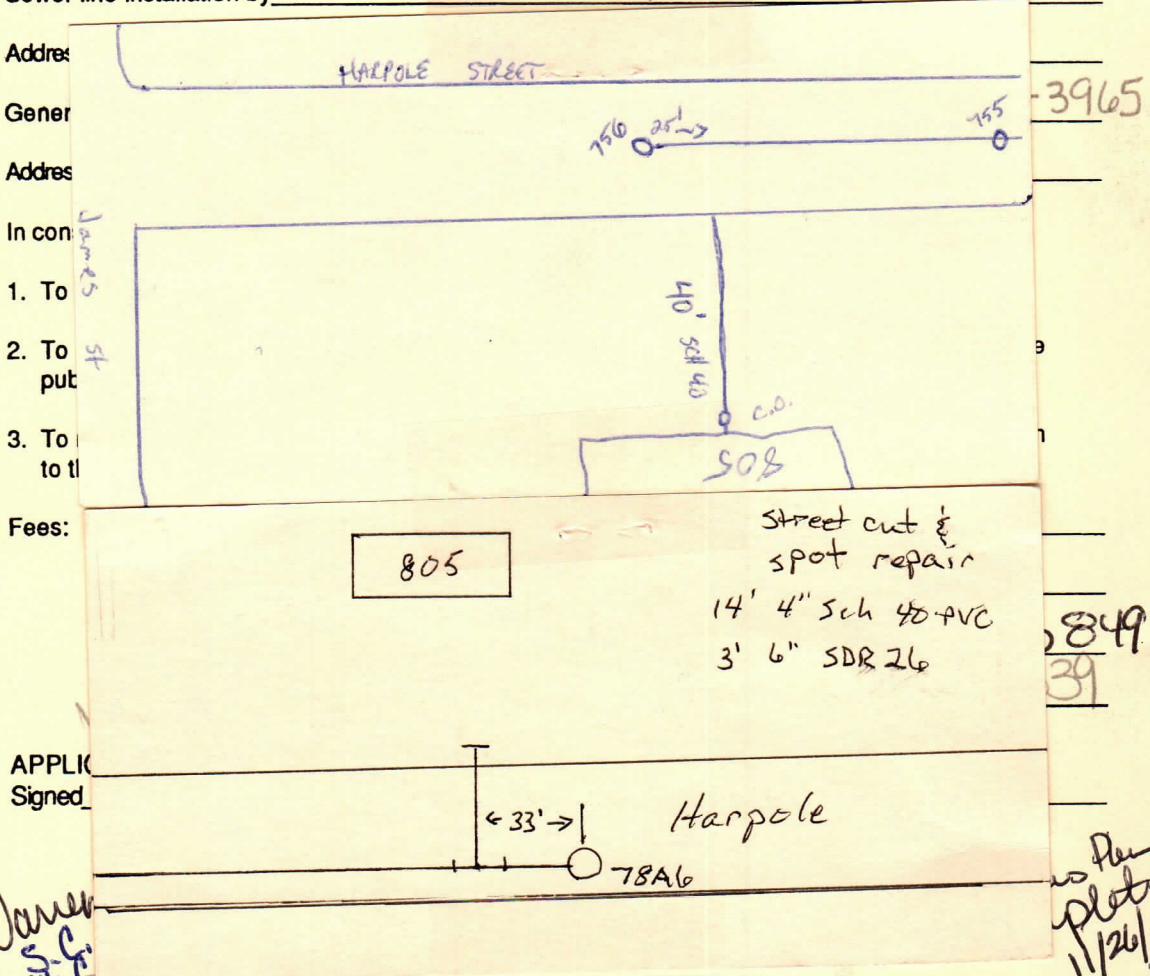

APPLICANT  
Signed \_\_\_\_\_

APPROVED  
Jacksonville Wastewater Utility

By: [Signature] Date: 11/19/20