



No. 98 - 174

## JACKSONVILLE WASTEWATER UTILITY

248 Cloverdale Road • P.O. Box 69  
Jacksonville, AR 72078-0069  
982-0581

## RESIDENTIAL OR COMMERCIAL BUILDING SEWER CONNECTION PERMIT

Street Address 808 Mable Street

Legal Description \_\_\_\_\_

Facility to be connected to sewer:

Single Family Residence ☒ \*Multi-family Residential \_\_\_\_\_ Units \_\_\_\_\_\*Commercial Installation \_\_\_\_\_ Description: single unit

Water Meter (s) Size \_\_\_\_\_

\* Commercial installations, and multi-family installations of more than 4 dwelling units must be accompanied by a site plan showing the proposed building sewer.

Sewer line installation by Sutton Pipe Line 6712975

Address \_\_\_\_\_

General \_\_\_\_\_

Address \_\_\_\_\_

In con \_\_\_\_\_

1. To \_\_\_\_\_

2. To \_\_\_\_\_

3. To \_\_\_\_\_

to t \_\_\_\_\_

Fees: \_\_\_\_\_

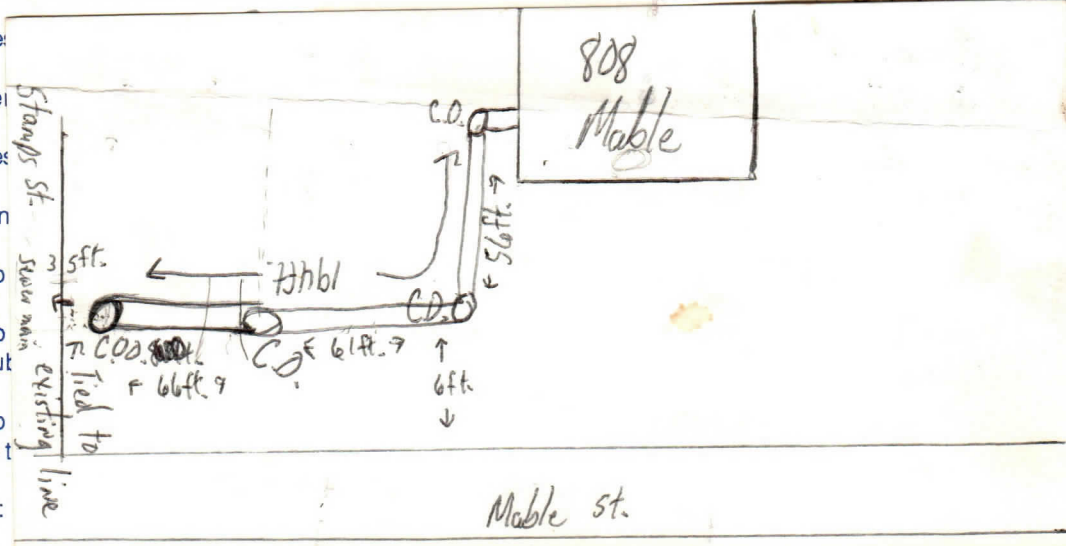

Tap Charge \$ \_\_\_\_\_

Receipt No. \_\_\_\_\_

Inspection Fee \$ 6.00Receipt No. 4621

Total Fees \$ \_\_\_\_\_

APPLICANT

Signed \_\_\_\_\_

☒ Plumbing Contractor☐ General Contract☐ Owner (Address \_\_\_\_\_)

APPROVED

Jacksonville Wastewater Utility

By: Dana Duncan Date: 7/10/98