



**JACKSONVILLE WASTEWATER UTILITY**  
248 Cloverdale Rd.  
Jacksonville, AR 72076  
501-982-0581

No. 23- **0083**

**RESIDENTIAL OR COMMERCIAL BUILDING SEWER CONNECTION PERMIT**

Street Address 826 Gene Drive

Legal Description \_\_\_\_\_

Facility to be connected to sewer:

Single Family Residence ✓ \*Multi-family Residential \_\_\_\_\_ Units \_\_\_\_\_

\*Commercial Installation \_\_\_\_\_ Description: Street cut / reroute

Water Meter (s) Size 5/8

\* Commercial installations, and multi-family installations of more than 4 dwelling units must be accompanied by a site plan showing the proposed building sewer.

Sewer line installation by 3 Gen Plumbers Mike 794-9378

Address \_\_\_\_\_

General Code \_\_\_\_\_

Address \_\_\_\_\_

In consideration of \_\_\_\_\_

1. To accept \_\_\_\_\_

2. To maintain public sewer \_\_\_\_\_

3. To notify \_\_\_\_\_ to the \_\_\_\_\_

Fee: \_\_\_\_\_

Tax \_\_\_\_\_

Ins \_\_\_\_\_

St \_\_\_\_\_

APPLICANT \_\_\_\_\_

Signed \_\_\_\_\_

☐

☐

☐

Mike

Donor

APPROVED \_\_\_\_\_

Jacksonville Wastewater Utility

By: [Signature] Date: 7/17/2023

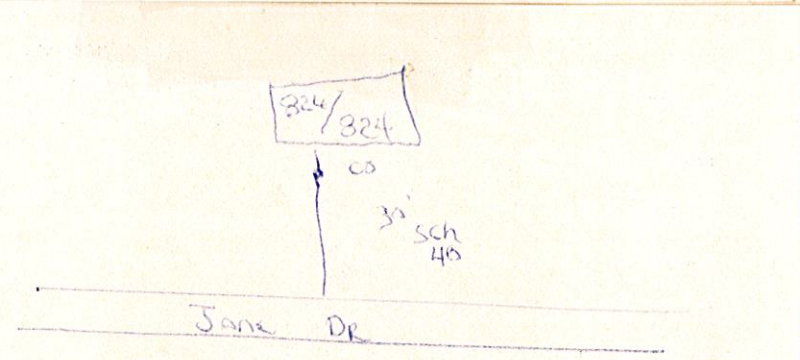
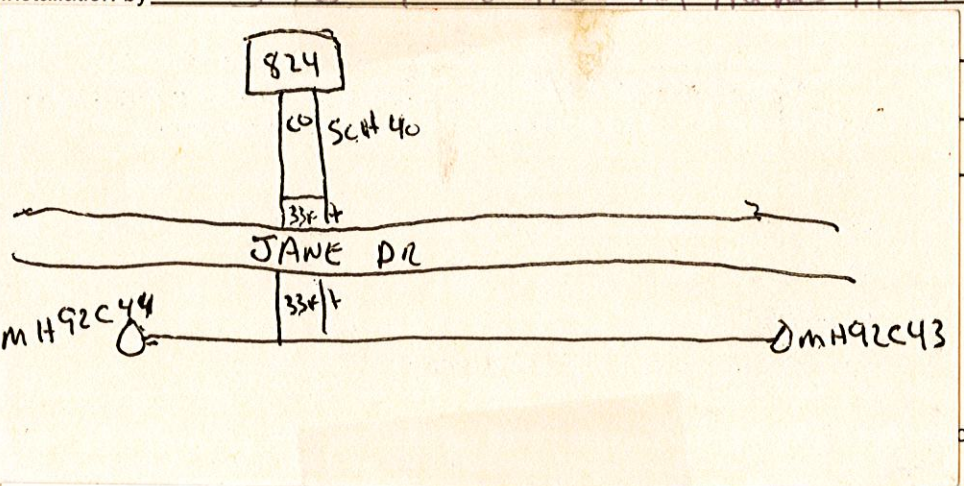

7/23  
7/18/2023