



JACKSONVILLE WASTEWATER UTILITY

248 Cloverdale Rd.
Jacksonville, AR 72076
501-982-0581

No. 13-0020

RESIDENTIAL OR COMMERCIAL BUILDING SEWER CONNECTION PERMIT

Street Address 8620 Hwy 161

Legal Description _____

Facility to be connected to sewer:

Single Family Residence _____ *Multi-family Residential _____ Units _____

*Commercial Installation _____ Description: New Connection

Water Meter (s) Size 5/8

* Commercial installations, and multi-family installations of more than 4 dwelling units must be accompanied by a site plan showing the proposed building sewer.

Sewer line installation by Mahan Plumbing - Wm 870-834-582

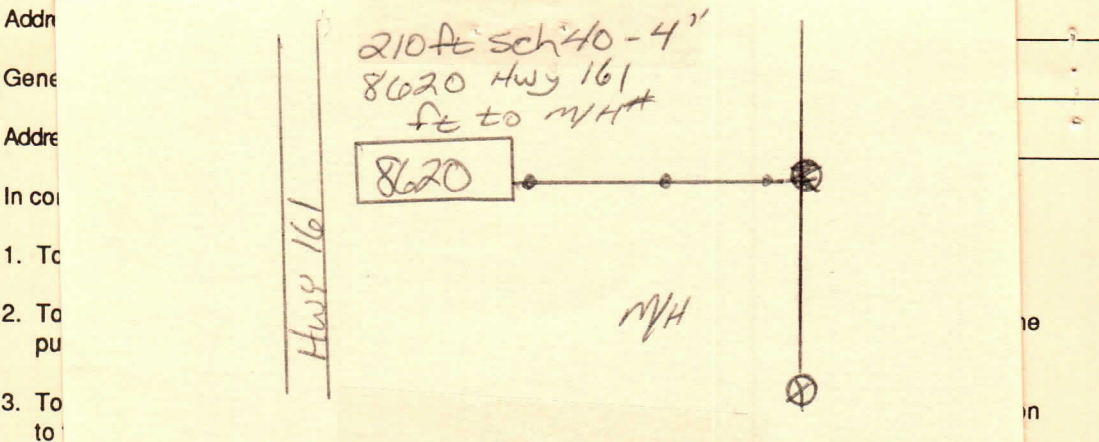

Fees: Connection Fee \$ 0

Receipt No. no chg

Tap Charge \$ _____

Receipt No. _____

Inspection Fee \$ 0

Receipt No. no chg

Street Cut \$ _____

Receipt No. 0

APPLICANT

Signed William Mahan

☒ Plumbing Contractor

☐ General Contract

☐ Owner (Address)

Peoples Brother Supply
501-519-3577

APPROVED

Jacksonville Wastewater Utility

By: John Havel Date: 2/11/13

Complete
2/12/13