



JACKSONVILLE WASTEWATER UTILITY
248 Cloverdale Rd.
Jacksonville, AR 72076
501-982-0581

No. 17- 096

RESIDENTIAL OR COMMERCIAL BUILDING SEWER CONNECTION PERMIT

Street Address 8713 Hwy 161

Legal Description _____

Facility to be connected to sewer:

Single Family Residence _____ *Multi-family Residential _____ Units _____

*Commercial Installation _____ Description: _____

Water Meter (s) Size _____

* Commercial installations, and multi-family installations of more than 4 dwelling units must be accompanied by a site plan showing the proposed building sewer.

Sewer line installation by Mahan Plumbing

Address _____

General _____

Address _____

In consideration _____

1. To a _____

2. To a _____
public _____

3. To a _____
to the _____

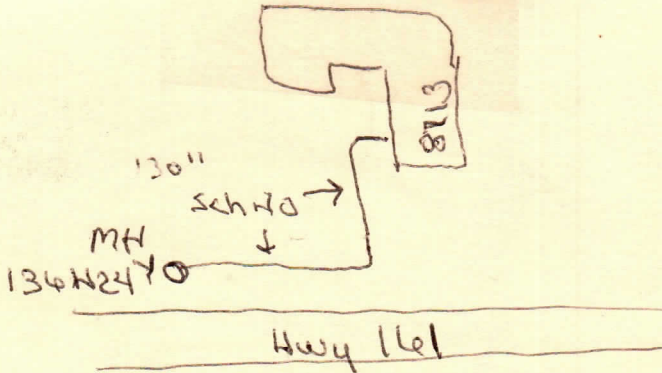

Fees: Connection Fee \$ 75.00

Receipt No. 174250

Tap Charge \$ _____

Receipt No. _____

Inspection Fee \$ 25.00

Receipt No. 174249 ✓

Street Cut \$ _____

Receipt No. _____

APPLICANT

Signed William

☐ Plumbing Contractor

☐ General Contract

☐ Owner (Address _____)

APPROVED

Jacksonville Wastewater Utility

By: Patricia Reed Date: 6/14/17

Complete
6/13/17