



JACKSONVILLE WASTEWATER UTILITY
248 Cloverdale Rd.
Jacksonville, AR 72076
501-982-0581

No. 09-0107

RESIDENTIAL OR COMMERCIAL BUILDING SEWER CONNECTION PERMIT

Street Address 900 Grazing Lane

Legal Description _____

Facility to be connected to sewer:

Single Family Residence ☒ *Multi-family Residential _____ Units _____

*Commercial Installation _____ Description: Replacement

Water Meter (s) Size 3/8

* Commercial installations, and multi-family installations of more than 4 dwelling units must be accompanied by a site plan showing the proposed building sewer.

Sewer line installation by Anderson Plumbing 743-5000

Address _____

General _____

Address _____

In connection with _____

1. To _____

2. To _____

3. To _____

to the _____

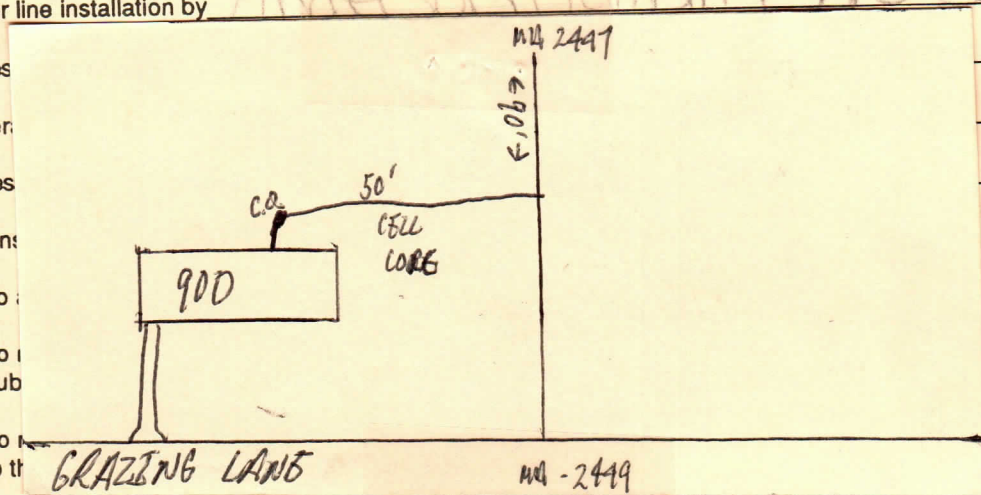

Fees: Connection Fee \$ _____ Receipt No. _____

Tap Charge \$ _____ Receipt No. _____

Inspection Fee \$ 35.00 Receipt No. on file

Street Cut \$ _____ Receipt No. _____

APPLICANT

Signed _____

☐ Plumbing Contractor

☐ General Contract

☐ Owner (Address _____)

APPROVED

Jacksonville Wastewater Utility

By: Jacob A. Day Date: 5/28/09

Completed
5/28/09