



JACKSONVILLE WASTEWATER UTILITY

248 Cloverdale Road • P.O. Box 69
Jacksonville, AR 72076
982-0581

No. 90- 000064

RESIDENTIAL OR COMMERCIAL BUILDING SEWER CONNECTION PERMIT

Street Address 900 Harvey

Legal Description _____

Facility to be connected to sewer:

Single Family Residence ☒ *Multi-family Residential _____ Units _____

*Commercial Installation _____ Description: Replacement

Water Meter (s) Size 5/8"

* Commercial installations, and multi-family installations of more than 4 dwelling units must be accompanied by a site plan showing the proposed building sewer.

Sewer line installation by Estes Plumbing

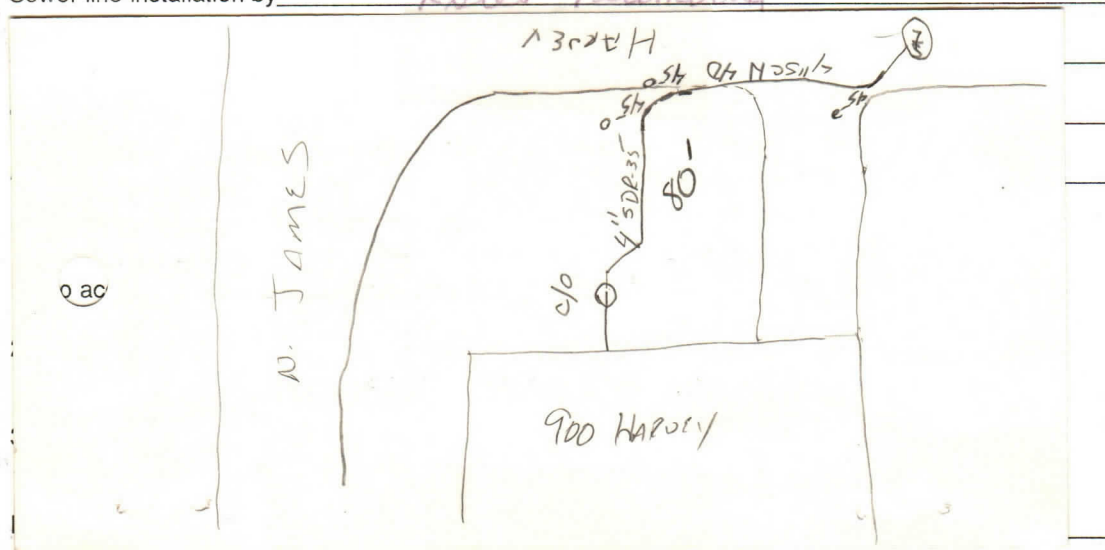

Tap Charge \$ _____

Receipt No. _____

Inspection Fee \$ 6.00

Receipt No. 90-0189 5-15-90

Total Fees \$ 6.00

APPLICANT

Signed [Signature]

☐ Plumbing Contractor

☐ General Contract

☐ Owner (Address _____)

APPROVED

Jacksonville Wastewater Utility

By: Hea Hughes Date: 5-15-90