



JACKSONVILLE WASTEWATER UTILITY

248 Cloverdale Road · P.O. Box 69
Jacksonville, AR 72078-0069
982-0581

No. 97-

131

RESIDENTIAL OR COMMERCIAL BUILDING SEWER CONNECTION PERMIT

Street Address 901 Madden

Legal Description _____

Facility to be connected to sewer:

Single Family Residence ☒ *Multi-family Residential _____ Units _____

*Commercial Installation _____ Description: replacement

Water Meter (s) Size 5/8"

* Commercial installations, and multi-family installations of more than 4 dwelling units must be accompanied by a site plan showing the proposed building sewer.

Sewer line installation by A A Able

Address _____

General Contractor _____

Address _____

In consideration of the granting of this permit the undersigned hereby agrees:

1. To accept and abide by all provisions of the Jacksonville Wastewater Utility Building Sewer Connection Permit.
2. To maintain the building sewer at no expense to the public sewer main.
3. To notify the utility's inspector when the building sewer is installed to the public sewer main, but before any portion is covered.

Fees: Connection Fee \$ _____

Tap Charge \$ 32.00

Inspection Fee \$ 6.00

Total Fees \$ _____

APPLICANT

Signed _____

☒ Plumbing Contractor

☐ General Contractor

☐ Owner (Address _____)

APPROVED

Jacksonville Wastewater Utility

By: D. Dunbar

Date: 7-1-71

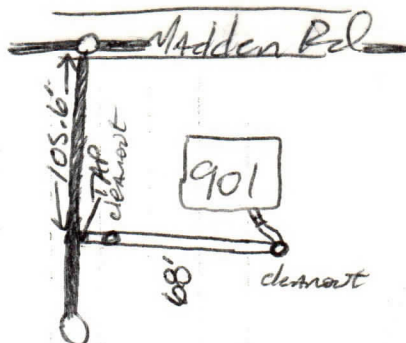



JACKSONVILLE WASTEWATER UTILITY
248 Cloverdale Rd.
Jacksonville, AR 72076
501-982-0581

No. 14- 0044

RESIDENTIAL OR COMMERCIAL BUILDING SEWER CONNECTION PERMIT

901 Madden Rd

Street Address _____

Legal Description _____

Facility to be connected to sewer:

Single Family Residence ☒ *Multi-family Residential _____ Units _____

*Commercial Installation _____ Description: Repair (section sink)

Water Meter (s) Size 5/8" _____

* Commercial installations, and multi-family installations of more than 4 dwelling units must be accompanied by a site plan showing the proposed building sewer.

Sewer line installation by Pride Plumbing Raymond Hunter 941-8781

Address _____

General Contractor _____

Address _____

In consideration of _____

1. To accept _____

2. To maintain public sewer _____

3. To notify the public _____

20' 3" Sch 40 PVC
Replaced sink drain

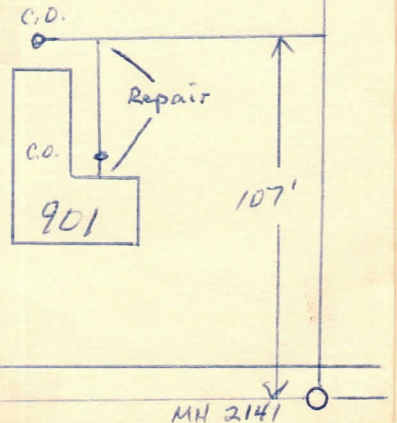

Fees: Connection Fee \$ _____ Receipt No. _____

Tap Charge \$ _____ Receipt No. _____

Inspection Fee \$ 25.00 Receipt No. 875068

Street Cut \$ _____ Receipt No. _____

APPLICANT Signed [Signature]

☐ Plumbing Contractor

☐ General Contractor

☐ Owner (Address _____)

APPROVED
Jacksonville Wastewater Utility

By: Jessica Kendrick Date: 4-17-14

Complete
4/17/14