



No. 09- 0118

JACKSONVILLE WASTEWATER UTILITY
248 Cloverdale Rd.
Jacksonville, AR 72076
501-982-0581

RESIDENTIAL OR COMMERCIAL BUILDING SEWER CONNECTION PERMIT

Street Address 909 Grazing Ln.

Legal Description _____

Facility to be connected to sewer:

Single Family Residence ☒ *Multi-family Residential _____ Units _____

*Commercial Installation _____ Description: Replacement

Water Meter (s) Size 5/8

* Commercial installations, and multi-family installations of more than 4 dwelling units must be accompanied by a site plan showing the proposed building sewer.

Sewer line installation by Anderson Plumbing 743-5002

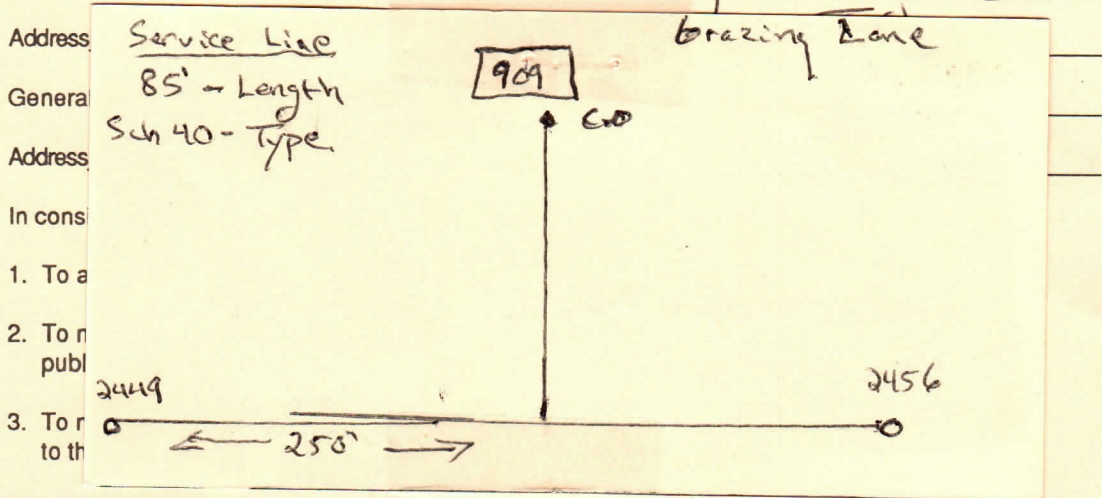

Fees:	Connection Fee	\$ _____	Receipt No. _____
	Tap Charge	\$ _____	Receipt No. _____
	Inspection Fee	\$ <u>25.00</u>	Receipt No. <u>on acct</u>
	Street Cut	\$ _____	Receipt No. _____

APPLICANT

Signed _____

- ☐ Plumbing Contractor
☐ General Contract

☒ Owner (Address _____)

Paul 6-15-07

APPROVED

Jacksonville Wastewater Utility

By: Sandra Juey Date: 6/15/07