



No. 01139

JACKSONVILLE WASTEWATER UTILITY

248 Cloverdale Road • P.O. Box 69
Jacksonville, AR 72078-0069
982-0581

RESIDENTIAL OR COMMERCIAL BUILDING SEWER CONNECTION PERMIT

Street Address 912 Elk HornLegal Description Lot #469 Northlake Subd. Walnut Pt

Facility to be connected to sewer:

Single Family Residence ☒ *Multi-family Residential _____ Units _____

*Commercial Installation _____ Description: _____

Water Meter (s) Size 5/8

* Commercial installations, and multi-family installations of more than 4 dwelling units must be accompanied by a site plan showing the proposed building sewer.

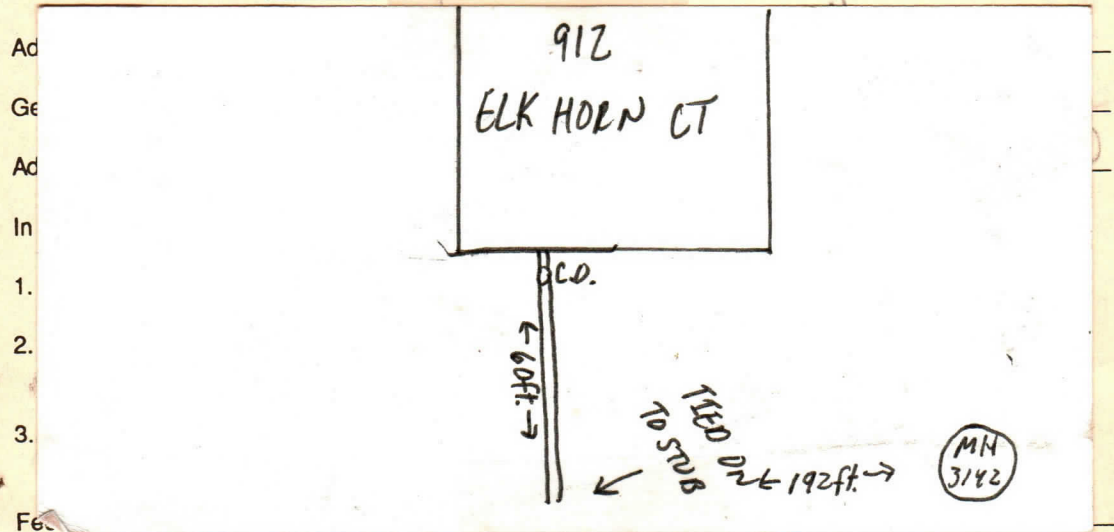
Sewer line installation by Tanglewood Plumbing

Tap Charge \$ _____

Receipt No. _____

Inspection Fee \$ 6.00 6/26/01Receipt No. 2068Total Fees \$ 75.00

APPLICANT

Signed Harry Mann☐ Plumbing Contractor☒ General Contract☐ Owner (Address _____)

APPROVED

Jacksonville Wastewater Utility

By: Melanie Green Date: 5/31/01