



Madjid Mart  
6/26/12  
**JACKSONVILLE WASTEWATER UTILITY**  
248 Cloverdale Road · P.O. Box 69  
Jacksonville, AR 72078-0069  
982-0581

No. 97-

080

**RESIDENTIAL OR COMMERCIAL BUILDING SEWER CONNECTION PERMIT**

Street Address 9128 Hwy 161 Jax.

Legal Description \_\_\_\_\_

Facility to be connected to sewer:

Single Family Residence \_\_\_\_\_ \*Multi-family Residential \_\_\_\_\_ Units \_\_\_\_\_

\*Commercial Installation ☒ Description: New Connection

Water Meter (s) Size 1"

\* Commercial installations, and multi-family installations of more than 4 dwelling units must be accompanied by a site plan showing the proposed building sewer.

Sewer line installation by Lewallen

Address \_\_\_\_\_

General Contractor Southern Road

Address \_\_\_\_\_

In consideration of the granting of this permit the undersigned agrees to:

1. To accept and abide by all provisions of the Jacksonville Wastewater Utility Ordinance.
2. To maintain the building sewer at no expense to the public sewer main.
3. To notify the utility's inspector when the building sewer is ready to be connected to the public sewer main, but before any portion of the building sewer is installed.

Fees: Connection Fee \$ 100.00

Tap Charge \$ 32.00

Inspection Fee \$ 6.00

Total Fees \$ 138.00

**APPLICANT**

Signed James [Signature]

- ☐ Plumbing Contractor  
☐ General Contractor  
☐ Owner (Address \_\_\_\_\_)

**APPROVED**

Jacksonville Wastewater Utility

By: Loren Stevens

Date: 2/24/12

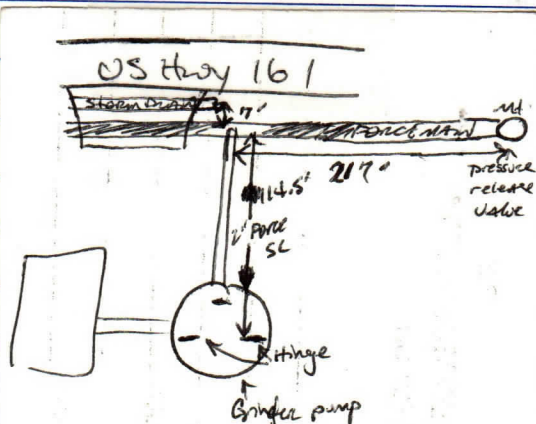



# JACKSONVILLE WASTEWATER UTILITY

248 Cloverdale Rd.  
Jacksonville, AR 72076  
501-982-0581

No. 12-0082

## RESIDENTIAL OR COMMERCIAL BUILDING SEWER CONNECTION PERMIT

Street Address 9128 S. Hwy 161

Legal Description Majid's Mart

Facility to be connected to sewer:

Single Family Residence \_\_\_\_\_ \*Multi-family Residential \_\_\_\_\_ Units \_\_\_\_\_

\*Commercial Installation ☒ Description: Force main valve phant

Water Meter (s) Size 5/8

\* Commercial installations, and multi-family installations of more than 4 dwelling units must be accompanied by a site plan showing the proposed building sewer.

Sewer line installation by Jurnal-Cody

Address \_\_\_\_\_

General \_\_\_\_\_

Address \_\_\_\_\_

In consid \_\_\_\_\_

1. To ac \_\_\_\_\_

2. To ma \_\_\_\_\_  
public \_\_\_\_\_

3. To no \_\_\_\_\_  
to the \_\_\_\_\_

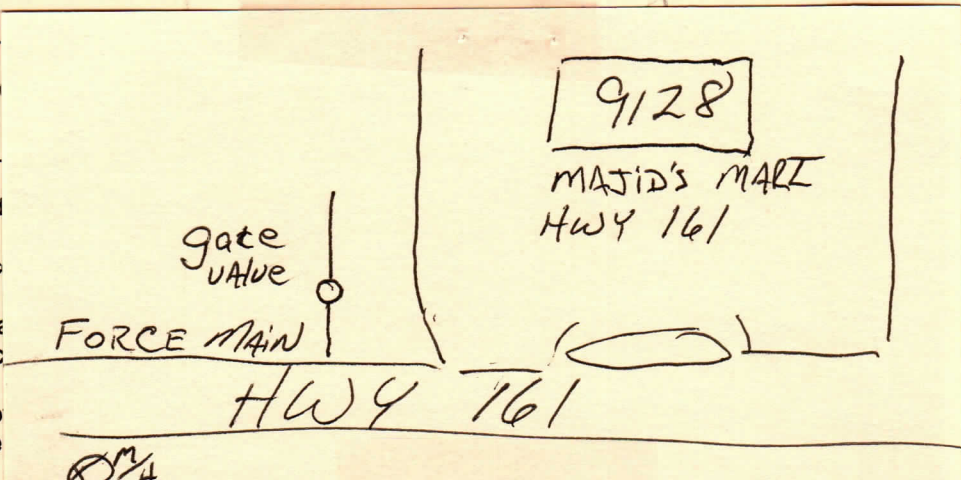

Fees: Connection Fee \$ \_\_\_\_\_ Receipt No. \_\_\_\_\_

Tap Charge \$ \_\_\_\_\_ Receipt No. \_\_\_\_\_

Inspection Fee \$ 0 Receipt No. nothing

Street Cut \$ \_\_\_\_\_ Receipt No. \_\_\_\_\_

### APPLICANT

Signed [Signature]

- ☐ Plumbing Contractor  
☐ General Contract  
☐ Owner (Address \_\_\_\_\_)

APPROVED  
Jacksonville Wastewater Utility

By: [Signature] Date: 6/26/12





JACKSONVILLE WASTEWATER UTILITY  
248 Cloverdale Rd.  
Jacksonville, AR 72076  
501-982-0581

No. 12-0083

RESIDENTIAL OR COMMERCIAL BUILDING SEWER CONNECTION PERMIT

Street Address 9128 S. Hwy 161

Legal Description Majid's Mart

Facility to be connected to sewer:

Single Family Residence \_\_\_\_\_ \*Multi-family Residential \_\_\_\_\_ Units \_\_\_\_\_

\*Commercial Installation ✓ Description: Replace check valve

Water Meter (s) Size \_\_\_\_\_ gate valve

\* Commercial installations, and multi-family installations of more than 4 dwelling units must be accompanied by a site plan showing the proposed building sewer.

Sewer line installation by A-OK Plumbing Vergil 918-8788

Address \_\_\_\_\_

General \_\_\_\_\_

Address \_\_\_\_\_

In consideration \_\_\_\_\_

1. To a Pump Station

2. To m 2" BALL VALVE

publi 2" UNION

3. To ne 5' Sch 40 2"

to the FORCE MAIN

Fees: Connection fee \$ \_\_\_\_\_ Receipt No. \_\_\_\_\_

Tap Charge \$ \_\_\_\_\_ Receipt No. \_\_\_\_\_

Inspection Fee \$ 25.00 Receipt No. 390192

Street Cut \$ \_\_\_\_\_ Receipt No. \_\_\_\_\_

APPLICANT \_\_\_\_\_

Signed [Signature]

☐ Plumbing Contractor

☐ General Contract

☐ Owner (Address \_\_\_\_\_)

APPROVED \_\_\_\_\_

Jacksonville Wastewater Utility

By: [Signature] Date: 6/27/12