



No 01142

JACKSONVILLE WASTEWATER UTILITY

248 Cloverdale Road · P.O. Box 69
Jacksonville, AR 72078-0069
982-0581

RESIDENTIAL OR COMMERCIAL BUILDING SEWER CONNECTION PERMIT

Street Address 978 Jamestown CircleLegal Description Lot 477 Collenwood Ph II

Facility to be connected to sewer:

Single Family Residence ☒ *Multi-family Residential _____ Units _____

*Commercial Installation _____ Description: _____

Water Meter (s) Size 5/8

* Commercial installations, and multi-family installations of more than 4 dwelling units must be accompanied by a site plan showing the proposed building sewer.

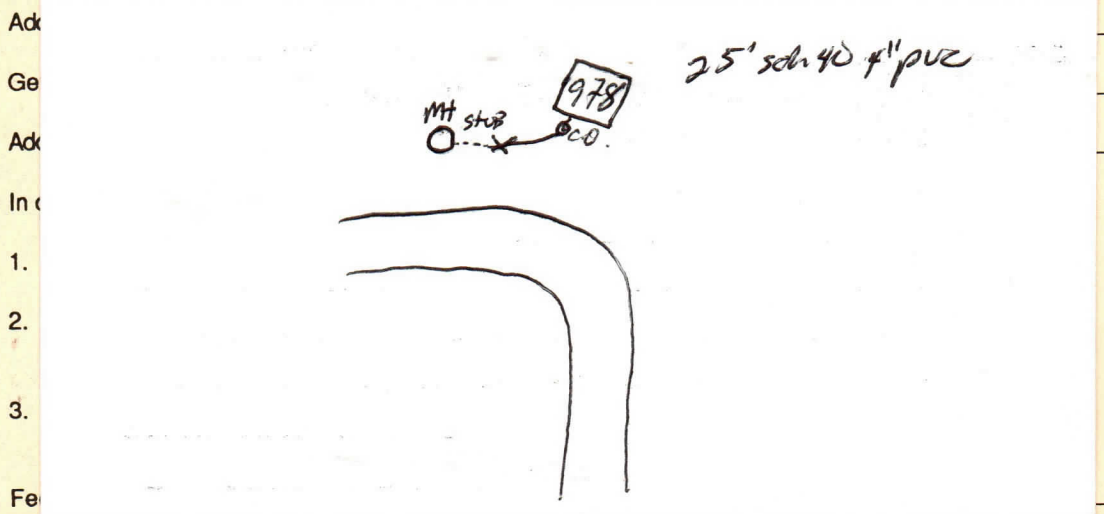
Sewer line installation by A-1 Plumbing

Tap Charge \$ _____

Receipt No. _____

Inspection Fee \$ 6.00 8/10/01Receipt No. 2137Total Fees \$ 75.14

APPLICANT

Signed _____

☐ Plumbing Contractor☐ General Contract☐ Owner (Address _____)

APPROVED

Jacksonville Wastewater Utility

By: M. B. B.Date: 6/12/01