



No. 00 462

**JACKSONVILLE WASTEWATER UTILITY**248 Cloverdale Road • P.O. Box 69  
Jacksonville, AR 72078-0069  
982-0581**RESIDENTIAL OR COMMERCIAL BUILDING SEWER CONNECTION PERMIT**Street Address 1308 N. First

Legal Description \_\_\_\_\_

Facility to be connected to sewer:

Single Family Residence ☒ \*Multi-family Residential \_\_\_\_\_ Units \_\_\_\_\_

\*Commercial Installation \_\_\_\_\_ Description: \_\_\_\_\_

Water Meter (s) Size \_\_\_\_\_

\* Commercial installations, and multi-family installations of more than 4 dwelling units must be accompanied by a site plan showing the proposed building sewer.

Sewer line installation by HAH Plumbing

Addr

Gen

Addr

In cr

1. T

2. T

F

3. T

t

Fee

API  
SignAPP  
Jac

By:

Date:

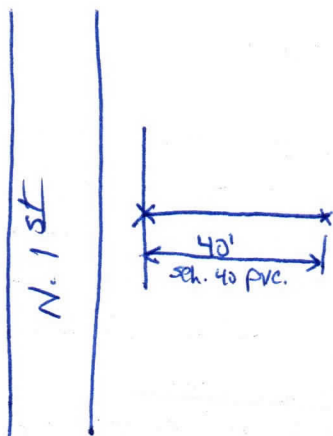

Partial

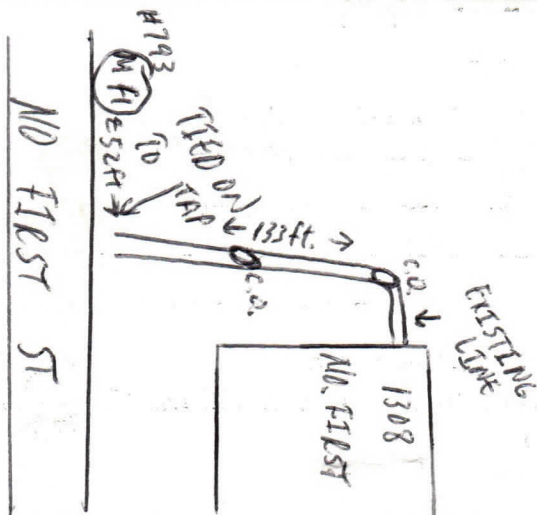



No. 01031

## JACKSONVILLE WASTEWATER UTILITY

248 Cloverdale Road • P.O. Box 69  
Jacksonville, AR 72078-0069  
982-0581

## RESIDENTIAL OR COMMERCIAL BUILDING SEWER CONNECTION PERMIT

Street Address 1308 N. FirstLegal Description Gene Wilson Mobile Home Park

Facility to be connected to sewer:

Single Family Residence \_\_\_\_\_ \*Multi-family Residential ☒ Units \_\_\_\_\_

\*Commercial Installation \_\_\_\_\_ Description: \_\_\_\_\_

Water Meter (s) Size \_\_\_\_\_

\* Commercial installations, and multi-family installations of more than 4 dwelling units must be accompanied by a site plan showing the proposed building sewer.

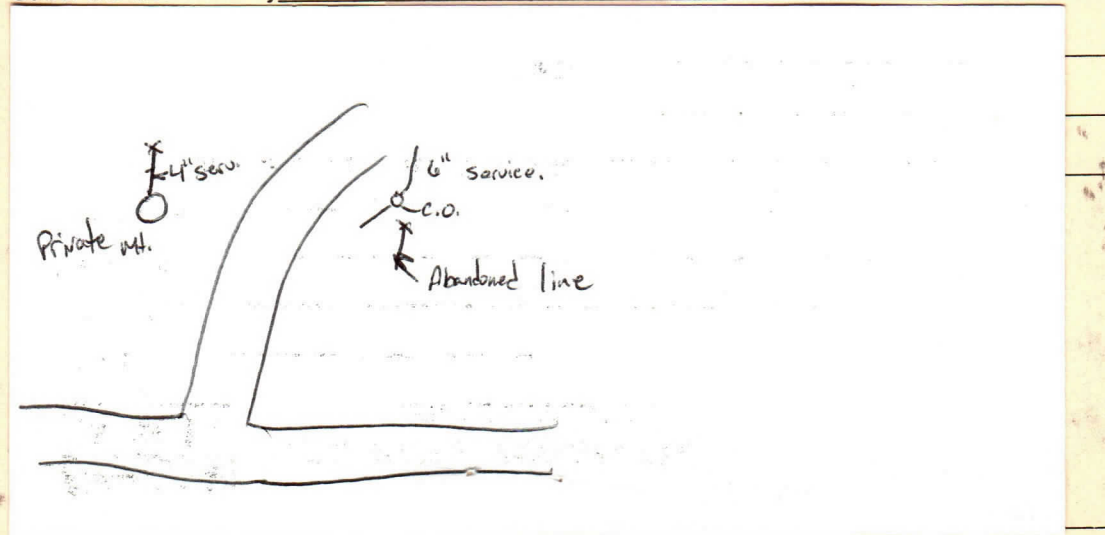
Sewer line installation by BOCO INC

Tap Charge \$ \_\_\_\_\_

Receipt No. \_\_\_\_\_

Inspection Fee \$ 6.00 x 2Receipt No. 2712Total Fees \$ 12.00

## APPLICANT

Signed \_\_\_\_\_

☐ Plumbing Contractor☐ General Contract☐ Owner (Address \_\_\_\_\_)

## APPROVED

Jacksonville Wastewater Utility

By: Cathy Reed Date: 1-10-01



JACKSONVILLE WASTEWATER UTILITY  
248 Cloverdale Rd.  
Jacksonville, AR 72076  
501-982-0581

No. 15- 000024

RESIDENTIAL OR COMMERCIAL BUILDING SEWER CONNECTION PERMIT

Street Address 1308 N. First St (next to driveway, curb)

Legal Description \_\_\_\_\_

Facility to be connected to sewer:

Single Family Residence ☒ \*Multi-family Residential \_\_\_\_\_ Units \_\_\_\_\_

\*Commercial Installation \_\_\_\_\_ Description: Cap service

Water Meter (s) Size 5/8

\* Commercial installations, and multi-family installations of more than 4 dwelling units must be accompanied by a site plan showing the proposed building sewer.

Sewer line installation by Vogel Mechanical Rile 944-4163

Address \_\_\_\_\_

General Contractor \_\_\_\_\_

Address \_\_\_\_\_

In consideration of \_\_\_\_\_

1. To accept \_\_\_\_\_

2. To maintain \_\_\_\_\_

3. To notify \_\_\_\_\_

Fees: Connection Fee \$ \_\_\_\_\_

Receipt No. \_\_\_\_\_

Tap Charge \$ \_\_\_\_\_

Receipt No. \_\_\_\_\_

Inspection Fee \$ 25.00

Receipt No. 423970

Street Cut \$ \_\_\_\_\_

Receipt No. \_\_\_\_\_

APPLICANT \_\_\_\_\_

Signed \_\_\_\_\_

☐ Plumbing Contractor

☐ General Contractor

☐ Owner (Address \_\_\_\_\_)

APPROVED \_\_\_\_\_

Jacksonville Wastewater Utility

By: [Signature] Date: 3/26/15

Complete  
8/27/15