



No. 99 0174

# JACKSONVILLE WASTEWATER UTILITY

248 Cloverdale Road · P.O. Box 69  
Jacksonville, AR 72078-0069  
982-0581

## RESIDENTIAL OR COMMERCIAL BUILDING SEWER CONNECTION PERMIT

1705 S Redmond Rd  
Street Address

Legal Description Pine Tree Manor Apts (5A)

Facility to be connected to sewer:

Single Family Residence ☒ \*Multi-family Residential ☐ Units

\*Commercial Installation ☐ Description: 585

Water Meter (s) Size 3/8

\* Commercial installations, and multi-family installations of more than 4 dwelling units must be accompanied by a site plan showing the proposed building sewer.

Sewer line installation by

Address

Gene

Address

In co

1. To

2. To

3. To

to

Fees:



### JACKSONVILLE WASTEWATER UTILITY SERVICE INSPECTION

PERMIT NO. \_\_\_\_\_

DATE: 6-7-99

OWNER: \_\_\_\_\_

ADDRESS: Redmond Rd. - Pine Tree Manor Apts - 5A

PLUMBER: \_\_\_\_\_

SERVICE LINE: ☒ OK ☐ REJECTED ☐ REASON: \_\_\_\_\_

SIGNED Doug Peters

Inspection Fee \$ 6.00

Receipt No. \_\_\_\_\_

Total Fees \$ \_\_\_\_\_

### APPLICANT

Signed

- ☐ Plumbing Contractor
- ☐ General Contract
- ☐ Owner (Address \_\_\_\_\_)

APPROVED  
Jacksonville Wastewater Utility

By: \_\_\_\_\_ Date: 6-7-99



No. 04- 0145

**JACKSONVILLE WASTEWATER UTILITY**248 Cloverdale Road • P.O. Box 69  
Jacksonville, AR 72078-0069  
982-0581**RESIDENTIAL OR COMMERCIAL BUILDING SEWER CONNECTION PERMIT**Street Address 1705 S. Redwood Road

Legal Description \_\_\_\_\_

Facility to be connected to sewer:

Single Family Residence \_\_\_\_\_ \*Multi-family Residential ☒ Units \_\_\_\_\_\*Commercial Installation \_\_\_\_\_ Description: Repair

Water Meter (s) Size \_\_\_\_\_

\* Commercial installations, and multi-family installations of more than 4 dwelling units must be accompanied by a site plan showing the proposed building sewer.

Sewer line installation by City of Jacksonville

Address \_\_\_\_\_

General Cont

Address \_\_\_\_\_

In consideration

1. To accept

2. To maintain  
public sewer3. To notify the  
to the public

Fees: Contr

Tap Charge

\$ \_\_\_\_\_

Inspection Fee

\$ 6.00

Street Cut

\$ \_\_\_\_\_

Receipt No. \_\_\_\_\_

Receipt No. 0145

Receipt No. \_\_\_\_\_

**APPLICANT**

Signed

- ☐
- Plumbing Contractor
- 
- ☐
- General Contractor
- 
- ☐
- Owner (Address \_\_\_\_\_)

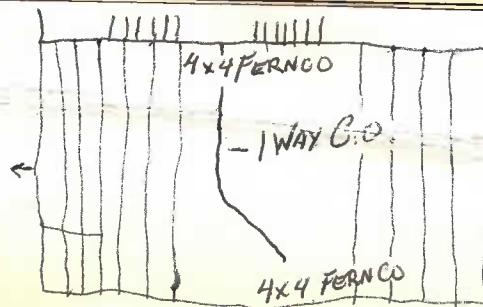
APPROVED  
Jacksonville Wastewater UtilityBy: \_\_\_\_\_Date: 27 June 2004



JACKSONVILLE WASTEWATER UTILITY  
248 Cloverdale Rd.  
Jacksonville, AR 72076  
501-982-0581

No. 06- 0175

RESIDENTIAL OR COMMERCIAL BUILDING SEWER CONNECTION PERMIT

Street Address 1705 S. Redmond Rd

Legal Description North Pine Garden Apts

Facility to be connected to sewer:

Single Family Residence \_\_\_\_\_ \*Multi-family Residential \_\_\_\_\_ Units \_\_\_\_\_

\*Commercial Installation \_\_\_\_\_ Description: Replacement

Water Meter (s) Size 5/8"

\* Commercial installations, and multi-family installations of more than 4 dwelling units must be accompanied by a site plan showing the proposed building sewer.

Sewer line installation by Advantage Services

Address \_\_\_\_\_

General Cont \_\_\_\_\_

Address \_\_\_\_\_

In consideration \_\_\_\_\_

1. To accept \_\_\_\_\_

2. To maintain  
public sewer \_\_\_\_\_

3. To notify the  
to the public \_\_\_\_\_

Fees: Conn \_\_\_\_\_

Tap Charge \$ \_\_\_\_\_

Inspection Fee \$ 12.00

Street Cut \$ \_\_\_\_\_

Receipt No. \_\_\_\_\_

Receipt No. 2476

Receipt No. \_\_\_\_\_

APPLICANT

Signed [Signature]

☐ Plumbing Contractor

☐ General Contract

☐ Owner (Address \_\_\_\_\_)

APPROVED

Jacksonville Wastewater Utility

By: Jessica Kendrick

Date: 7-12-06

Inspected  
7-13-06



No. 07-0102

## JACKSONVILLE WASTEWATER UTILITY

248 Cloverdale Rd.  
Jacksonville, AR 72076  
501-982-0581

## RESIDENTIAL OR COMMERCIAL BUILDING SEWER CONNECTION PERMIT

Street Address 1705 Redmond Rd

Legal Description \_\_\_\_\_

Facility to be connected to sewer:

Single Family Residence \_\_\_\_\_ \*Multi-family Residential ☒ Units \_\_\_\_\_

\*Commercial Installation \_\_\_\_\_ Description: \_\_\_\_\_

Water Meter (s) Size 5/8"

\* Commercial installations, and multi-family installations of more than 4 dwelling units must be accompanied by a site plan showing the proposed building sewer.

Sewer line installation by D+K PlumbingAddress 1011 E. Woodson Lane

General Contractor

Address \_\_\_\_\_

In consideration of

1. To accept a
2. To maintain public sewer
3. To notify the public

Fees: Connection

Tap Charge \$ \_\_\_\_\_

Inspection Fee \$ 12.00

Street Cut \$ \_\_\_\_\_

Receipt No. \_\_\_\_\_

Receipt No. 932

Receipt No. \_\_\_\_\_

APPLICANT

Signed Kristopher Woods☐ Plumbing Contractor☐ General Contractor☐ Owner (Address \_\_\_\_\_)

APPROVED

Jacksonville Wastewater Utility

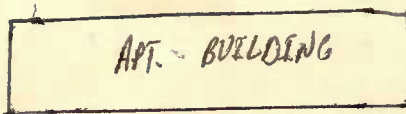
By: Jessica Kendrick Date: 6-19-07

SPOT REPAIR

Inspected  
6-19-07





JACKSONVILLE WASTEWATER UTILITY  
248 Cloverdale Rd.  
Jacksonville, AR 72076  
501-982-0581

No. 08- 0014

RESIDENTIAL OR COMMERCIAL BUILDING SEWER CONNECTION PERMIT

Street Address 1705 Redmond Rd

Legal Description Manor House Apts

Facility to be connected to sewer:

Single Family Residence \_\_\_\_\_ \*Multi-family Residential ☒ Units \_\_\_\_\_

\*Commercial Installation \_\_\_\_\_ Description: Replacement

Water Meter (s) Size 3/8"

\* Commercial installations, and multi-family installations of more than 4 dwelling units must be accompanied by a site plan showing the proposed building sewer.

Sewer line installation by Henry's Hometown Plumbing

Address MP 5659 501 605 7732

General Cont

Address \_\_\_\_\_

In consideration

1. To accept
2. To maintain public sewer
3. To notify the public to the public

Fees: Conr

Tap Charge \$ \_\_\_\_\_

Receipt No. \_\_\_\_\_

Insp

Stre

APPLICANT  
Signed \_\_\_\_\_

- ☐ F  
☐ C  
☐ C

APPROVED  
Jacksonville

By: \_\_\_\_\_

