



No. 05-0084

JACKSONVILLE WASTEWATER UTILITY248 Cloverdale Road • P.O. Box 69
Jacksonville, AR 72078-0069
982-0581**RESIDENTIAL OR COMMERCIAL BUILDING SEWER CONNECTION PERMIT**Street Address 873 + 875 Jane Drive

Legal Description _____

Facility to be connected to sewer:

Single Family Residence _____ *Multi-family Residential _____ Units _____

*Commercial Installation _____ Description: Replacement

Water Meter (s) Size _____

* Commercial installations, and multi-family installations of more than 4 dwelling units must be accompanied by a site plan showing the proposed building sewer.

Sewer line installation by Kens Express Plumbing

Address _____

General Contractor _____

Address _____

In consideration of the granting of this permit the user agrees to:

1. To accept and abide by all provisions of the Jacksonville Wastewater Utility Ordinance.
2. To maintain the building sewer at no expense to the public sewer main.
3. To notify the utility's inspector when the building sewer is installed to the public sewer main, but before any portion is covered.

Fees:	Connection Fee	\$ _____
	Tap Charge	\$ _____
	Inspection Fee	\$ <u>12.00</u>
	Street Cut	\$ _____

APPLICANT

Signed _____

- ☐ Plumbing Contractor
☐ General Contract
☐ Owner (Address _____)

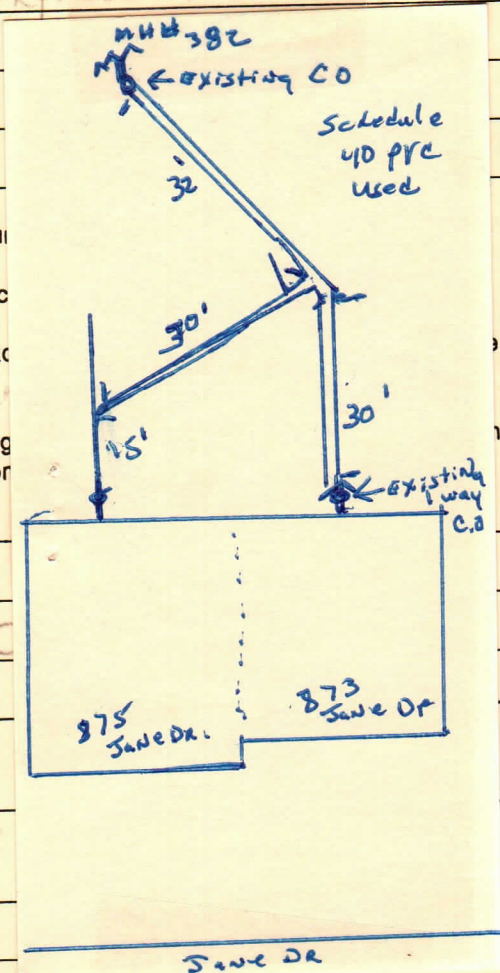
APPROVED
Jacksonville Wastewater UtilityBy: [Signature] Date: 21 July 05



JACKSONVILLE WASTEWATER UTILITY

248 Cloverdale Rd.
Jacksonville, AR 72076
501-982-0581

No. 08- 0134

RESIDENTIAL OR COMMERCIAL BUILDING SEWER CONNECTION PERMIT

Street Address 873 / 875 Jane Drive

Legal Description _____

Facility to be connected to sewer:

Single Family Residence _____ *Multi-family Residential ☒ Units 2

*Commercial Installation _____ Description: Replacement

Water Meter (s) Size 5/8"

* Commercial installations, and multi-family installations of more than 4 dwelling units must be accompanied by a site plan showing the proposed building sewer.

Sewer line installation by Precision Plumbing

Address _____

General _____

Address _____

In consid _____

1. To acc _____

2. To ma public _____

3. To not to the _____

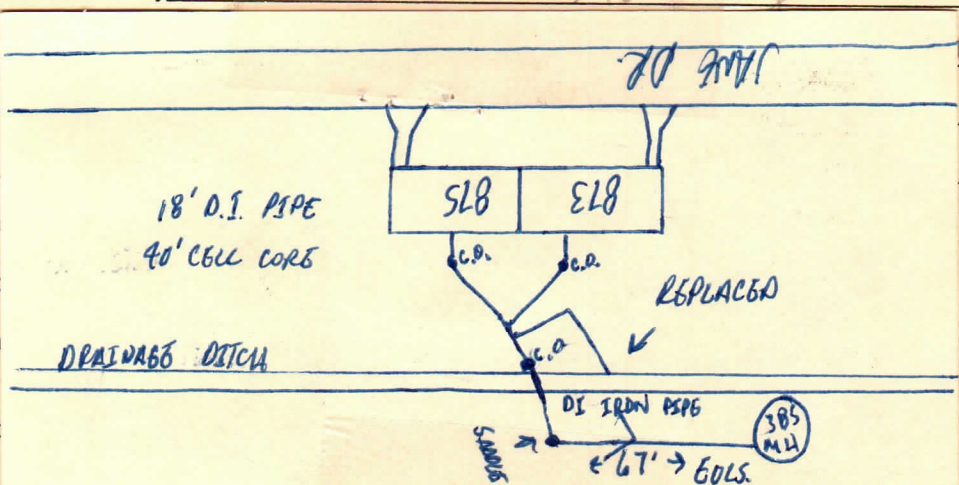

Fees: Connection Fee \$ _____

Receipt No. _____

Tap Charge \$ _____

Receipt No. _____

Inspection Fee \$ 25.00

Receipt No. 356

Street Cut \$ _____

Receipt No. _____

APPLICANT

Signed _____

☐ Plumbing Contractor

☐ General Contract

☐ Owner (Address _____)

APPROVED

Jacksonville Wastewater Utility

By: Jessica Kendrick Date: 10-13-08

Completed
10-14-08



JACKSONVILLE WASTEWATER UTILITY
248 Cloverdale Rd.
Jacksonville, AR 72076
501-982-0581

No. 11-

149

RESIDENTIAL OR COMMERCIAL BUILDING SEWER CONNECTION PERMIT

Street Address 125 Roosevelt

Legal Description 875 Jane Drive

Facility to be connected to sewer:

Single Family Residence ☒ *Multi-family Residential ☐ Units ☐

*Commercial Installation ☐ Description: Capped Service

Water Meter (s) Size

* Commercial installations, and multi-family installations of more than 4 dwelling units must be accompanied by a site plan showing the proposed building sewer.

Sewer line installation by JWWU - Todd

Address Capped Svc

General ☐

Address ☐

In consid 385 66.7 new mt

1. To ac

2. To ma public

3. To not to the Jane Drive

Fees: Connection Fee \$ Receipt No.

Tap Charge \$ Receipt No.

Inspection Fee \$ 0 Receipt No. No charge

Street Cut \$ Receipt No.

APPLICANT

Signed N/A

☐ Plumbing Contractor

☐ General Contract

☐ Owner (Address) Complete

APPROVED

Jacksonville Wastewater Utility

By: Jessica Perdue Date: 12/15/11