



No. 98 - 216

JACKSONVILLE WASTEWATER UTILITY

248 Cloverdale Road · P.O. Box 69
Jacksonville, AR 72078-0069
982-0581

RESIDENTIAL OR COMMERCIAL BUILDING SEWER CONNECTION PERMIT

Street Address 421 Center

Legal Description _____

Facility to be connected to sewer:

Single Family Residence X *Multi-family Residential _____ Units _____*Commercial Installation _____ Description: KeptWater Meter (s) Size 5/8

* Commercial installations, and multi-family installations of more than 4 dwelling units must be accompanied by a site plan showing the proposed building sewer.

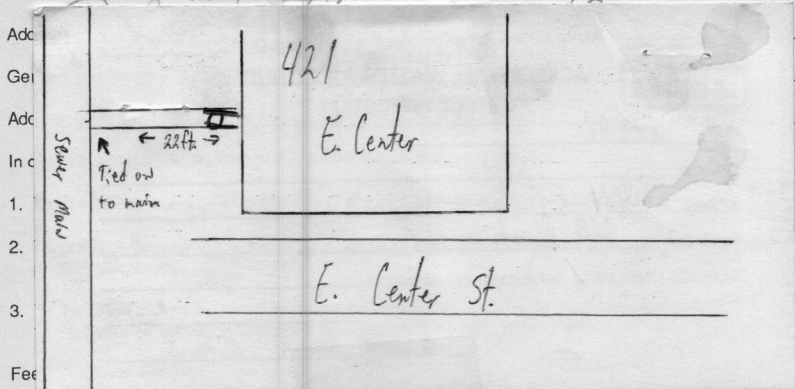
Sewer line installation by AAA Plumbing, 9856360

Tap Charge \$ _____

Inspection Fee \$ 6.00

Total Fees \$ _____

Receipt No. _____

Receipt No. 4513

APPLICANT

Signed per phone Janice☒ Plumbing Contractor☐ General Contract☐ Owner (Address _____)APPROVED
Jacksonville Wastewater UtilityBy: Karen Stivers Date: 8-19-98