



JACKSONVILLE WASTEWATER UTILITY

248 Cloverdale Road • P.O. Box 69

Jacksonville, AR 72078-0069

982-0581

RESIDENTIAL OR COMMERCIAL BUILDING SEWER CONNECTION PERMIT

Street Address

609 N Cloverdale

Legal Description

Facility to be connected to sewer:

Single Family Residence



*Multi-family Residential

Units

*Commercial Installation

Description:

Replacement

Water Meter (s) Size

* Commercial installations, and multi-family installations of more than 4 dwelling units must be accompanied by a site plan showing the proposed building sewer.

Sewer line installation by

Address

General Contractor

Kenneth Tucker

Address

In con:

1. To

2. To

put

3. To

to tl

Fees:

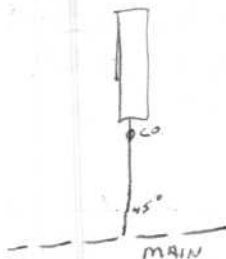

Total Fees

\$ 40.00

APPLICANT

Signed

Lemmy L. Miller

☐ Plumbing Contractor☐ General Contract☐ Owner (Address)

APPROVED

Jacksonville Wastewater Utility

By:

Luis M. Leonard

Date:

3-27-95



No. 98 - 019

JACKSONVILLE WASTEWATER UTILITY

248 Cloverdale Road • P.O. Box 69
Jacksonville, AR 72078-0069
982-0581

RESIDENTIAL OR COMMERCIAL BUILDING SEWER CONNECTION PERMIT

Street Address 609 B CloverdaleLegal Description off Bricklake Lane

Facility to be connected to sewer:

Single Family Residence X *Multi-family Residential _____ Units _____

*Commercial Installation _____ Description: _____

Water Meter (s) Size 5/8

* Commercial installations, and multi-family installations of more than 4 dwelling units must be accompanied by a site plan showing the proposed building sewer.

Sewer line installation by AAA PlumbingAddress Cloverdale

Gene _____

Address [Box]

In col _____

1. To [Box]2. To [Box]
pu3. To [Box]
to

Fees:

Tap Charge \$ 32.06Inspection Fee \$ 600.

Total Fees \$ _____

Receipt No. 9026

Receipt No. _____

APPLICANT
Signed [Signature]☒ Plumbing Contractor☐ General Contract☐ Owner (Address _____)APPROVED
Jacksonville Wastewater UtilityBy: Karen Stivers Date: 2-9-98



No. 01125

JACKSONVILLE WASTEWATER UTILITY

248 Cloverdale Road · P.O. Box 69
Jacksonville, AR 72078-0069
982-0581

RESIDENTIAL OR COMMERCIAL BUILDING SEWER CONNECTION PERMIT

Street Address 609 C Cloverdale Road

Legal Description _____

Facility to be connected to sewer:

Single Family Residence ☒ *Multi-family Residential _____ Units _____*Commercial Installation _____ Description: tapWater Meter (s) Size 5/8

* Commercial installations, and multi-family installations of more than 4 dwelling units must be accompanied by a site plan showing the proposed building sewer.

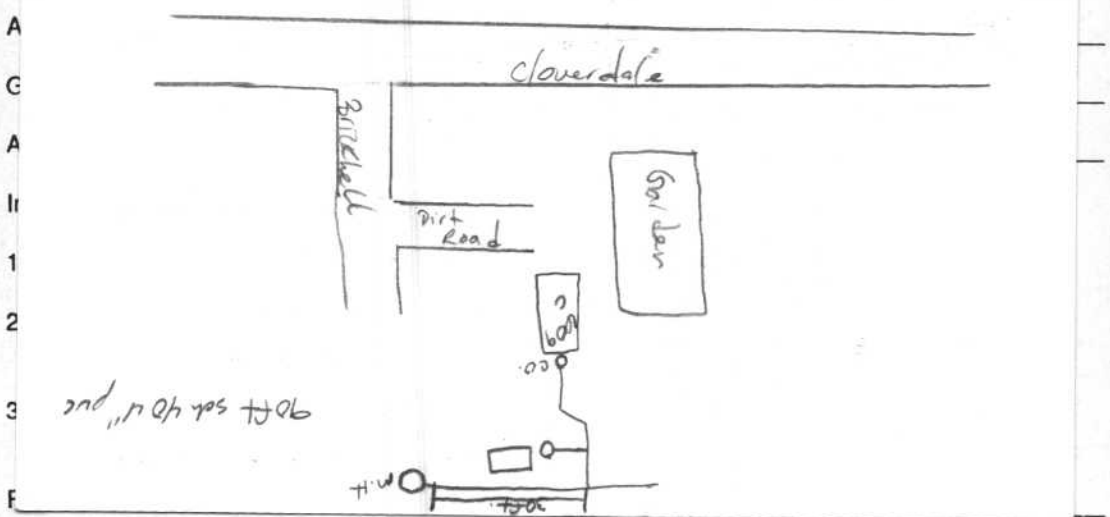
Sewer line installation by AAA PlumbingTap Charge \$ 36.56Receipt No. 2823Inspection Fee \$ 6.00Receipt No. 2823Total Fees \$ 42.56

APPLICANT

Signed see phone Janice☒ Plumbing Contractor☐ General Contract☐ Owner (Address _____)

APPROVED

Jacksonville Wastewater Utility

By: Cathy Reed Date: 4-10-01