



JACKSONVILLE WASTEWATER UTILITY

248 Cloverdale Rd.
Jacksonville, AR 72076
501-982-0581

No. 12-0047

RESIDENTIAL OR COMMERCIAL BUILDING SEWER CONNECTION PERMIT

Street Address 3101 N. First St

Legal Description Bldg 2 31 units

Facility to be connected to sewer:

Single Family Residence ☒ *Multi-family Residential ☐ Units ☐

*Commercial Installation ☐ Description: New Connection

Water Meter (s) Size 5/8

* Commercial installations, and multi-family installations of more than 4 dwelling units must be accompanied by a site plan showing the proposed building sewer.

Sewer line installation by Harden Plumbing

Address _____

General Contractor Shawn O'Dell

Address 726 Lake Street

In consideration of the granting of this permit the undersigned

1. To accept and abide by all provisions of the Jacksonville
2. To maintain the building sewer at no expense to the Utility public sewer main.
3. To notify the utility's inspector when the building sewer to the public sewer main, but before any portion of the

Fees: Connection Fee \$ 225.00

Tap Charge \$ _____

Inspection Fee \$ 25.00

Street Cut \$ _____

APPLICANT

Signed Shawn O'Dell

☐ Plumbing Contractor

☐ General Contract

☐ Owner (Address _____)

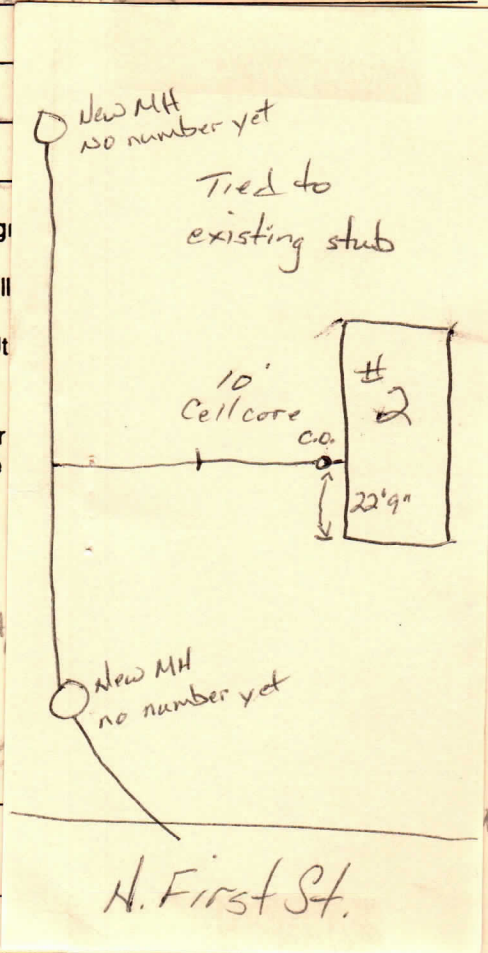

APPROVED
Jacksonville Wastewater Utility

By: [Signature] Date: 4/18/12