



JACKSONVILLE WASTEWATER UTILITY
248 Cloverdale Rd.
Jacksonville, AR 72076
501-982-0581

No. 17-054

RESIDENTIAL OR COMMERCIAL BUILDING SEWER CONNECTION PERMIT

Street Address 2001 General Samuels

Legal Description _____

Facility to be connected to sewer:

Single Family Residence _____ *Multi-family Residential _____ Units _____

*Commercial Installation ☒ Description: New Connection

Size _____

Installations, and multi-family installations of more than 4 dwelling units must be a site plan showing the proposed building sewer.

Installation by Lynn Plumbing Michael 281-0868

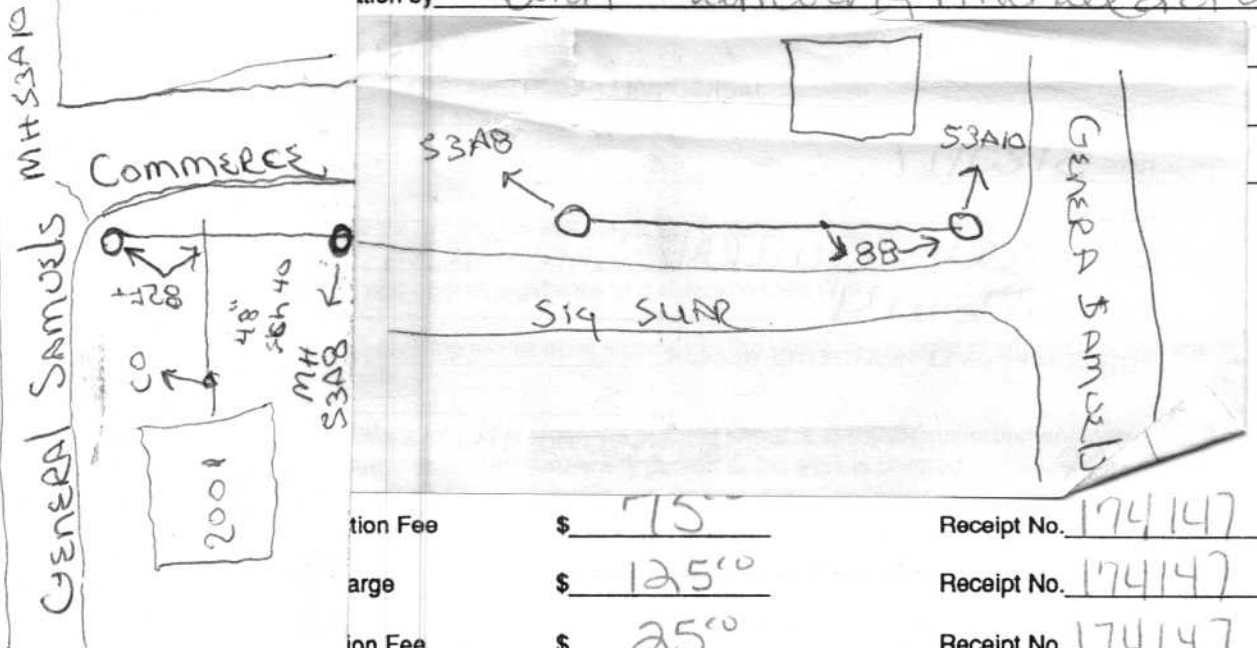

Installation Fee \$ 75

Receipt No. 174147

Large \$ 125

Receipt No. 174147

Installation Fee \$ 25

Receipt No. 174147

Out \$ _____

Receipt No. _____

Signed _____

- ☐ Plumbing Contractor
- ☐ General Contract
- ☐ Owner (Address _____)

Daniel M
APPROVED

Jacksonville Wastewater Utility

By: [Signature]

Date: 3/20/17

Tap complete
3/20/17
Complete
3/20/17