



No. 09-0000261

JACKSONVILLE WASTEWATER UTILITY

**248 Cloverdale Rd.
Jacksonville, AR 72076
501-982-0581**

RESIDENTIAL OR COMMERCIAL BUILDING SEWER CONNECTION PERMIT

Street Address 1911 B - Graham

Legal Description

Facility to be connected to sewer:

Single Family Residence ✓ *Multi-family Residential _____ Units _____

*Commercial Installation Description: Kitchen

Water Meter (s) Size 1.5

- * Commercial installations, and multi-family installations of more than 4 dwelling units must be accompanied by a site plan showing the proposed building sewer.

Sewer line installation by Master Plumbing - Charles

Address _____

General Co		
------------	--	--

Address				
---------	--	--	--	--

In consider

1. To accept
2. To maintain public safety
3. To notify to the public

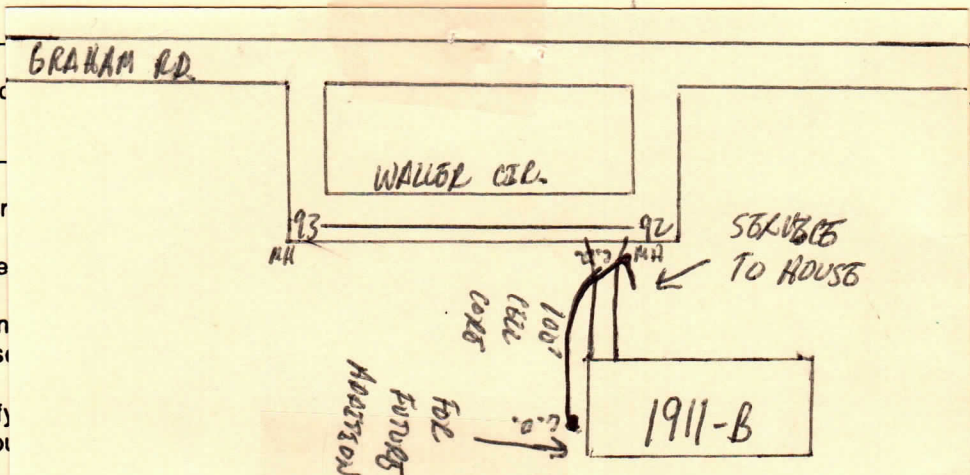

Fees:	Connection Fee	\$
--------------	-----------------------	-----------

Receipt No.

Tap Charge \$

Receipt No. _____

Inspection Fee \$ 25

Receipt No. 014007

Street Cut \$

Receipt No. _____

APPLICANT

Signed on file

- ☐
- Plumbing Contractor

- ☐ General Contract

- ☐
- Owner (Address

APPROVED

Jacksonville Wastewater Utility

By: William Alford Date: 12/3/09